

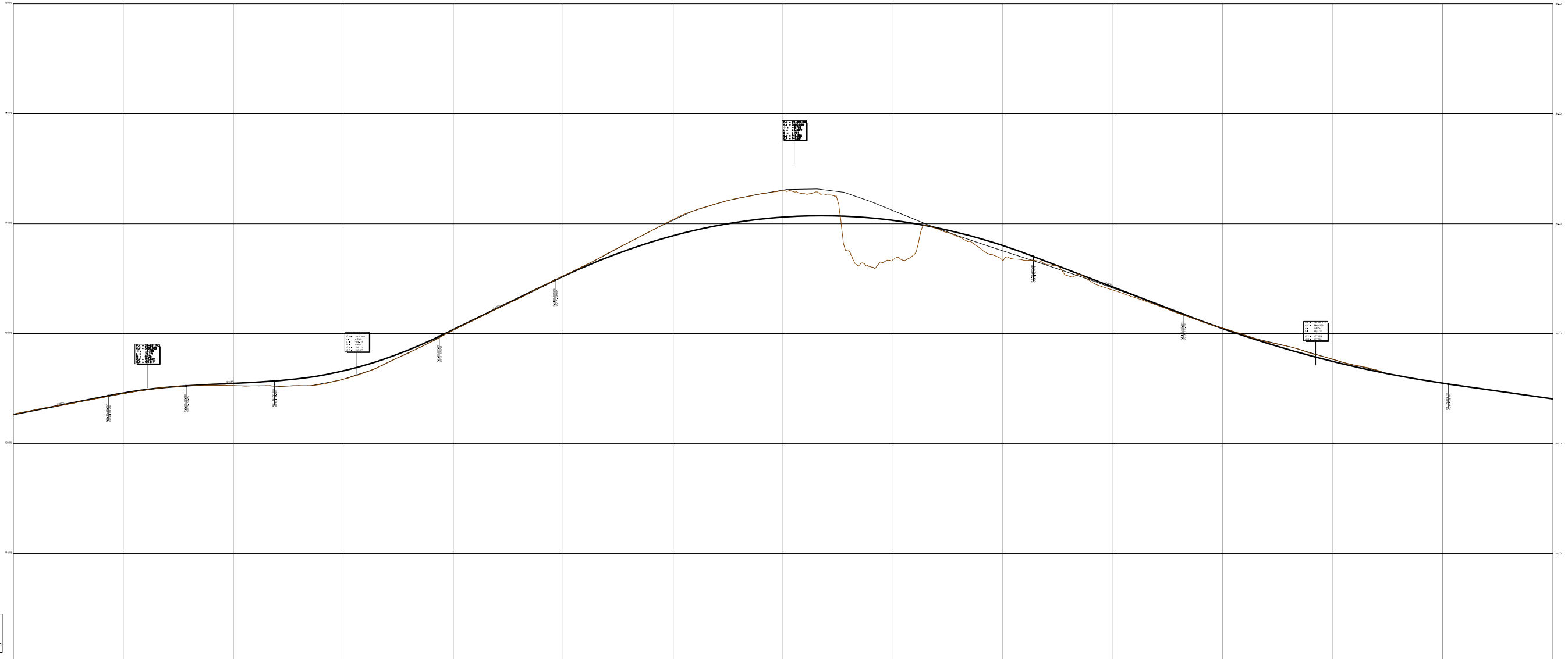

ALTERNATIV 4



STATION	29+500.00	29+600.00	29+700.00	29+800.00	29+900.00	29+1000.00	29+1100.00	29+1200.00	29+1300.00	29+1400.00	29+1500.00	29+1600.00	29+1700.00	29+1800.00	29+1900.00	29+2000.00
EXISTING LEVEL	100.00	100.50	101.00	101.50	102.00	103.00	104.00	105.00	106.00	107.00	108.00	109.00	110.00	111.00	112.00	113.00
DESIGN LEVEL	100.00	100.50	101.00	101.50	102.00	103.00	104.00	105.00	106.00	107.00	108.00	109.00	110.00	111.00	112.00	113.00
CHANGES																
CURVATURE	→		→				→				→				→	
SUPERELEVATION	→		→				→				→				→	

PROFILE ALTERNATIV 4
 Escala H: 500
 Escala V: 50

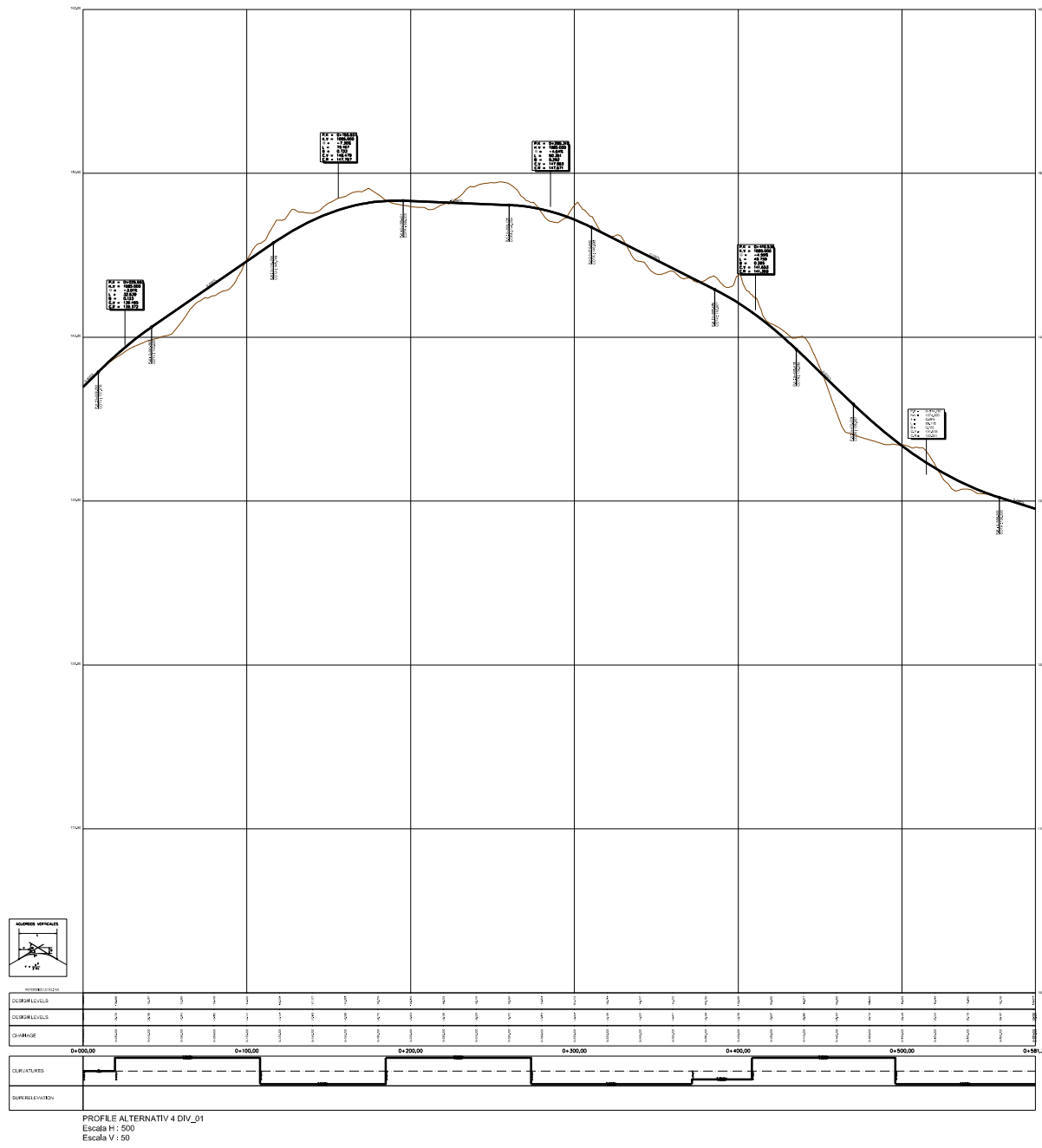

CUT: 8.351 m2
 FILL: 0.000 m2

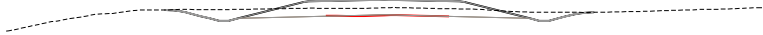

COTA DE REFERENCIA : 124.000 m.

DESIGNED LEVELS	EXISTING LEVELS	OFFSET
	126.123	
	126.429	
	126.615	
	126.736	
	126.898	
	127.045	
	127.148	
	127.234	
	127.224	
	127.262	
	127.187	
	127.370	
	127.283	
	127.297	
	127.322	
	127.677	
	127.696	
	127.315	
	127.304	
	127.311	
	127.356	
	127.777	
	127.324	
	127.324	
	127.303	
	127.696	
	127.677	
	127.275	
	127.234	
	127.168	
	127.126	
	127.113	
	127.112	
	127.105	
	127.105	
	126.953	
	127.097	
	127.065	
	127.102	
	127.114	
	127.144	
	127.154	
	127.196	
	127.235	
	127.264	
	127.284	
	127.344	

PUNTO KILOMÉTRICO : 28+840

CUT: 11.973 m2
 FILL: 1.524 m2



COTA DE REFERENCIA : 126.000 m.

DESIGNED LEVELS	EXISTING LEVELS	OFFSET
	128.861	
	128.833	
	128.742	
	128.531	
	128.391	
	128.402	
	128.423	
	128.526	
	128.559	
	128.624	
	128.687	
	128.734	
	128.889	
	129.413	
	129.116	
	129.306	
	129.717	
	129.926	
	130.085	
	130.282	
	130.266	
	130.315	
	130.320	
	130.298	
	130.241	
	130.137	
	130.264	
	130.064	
	130.051	
	130.092	
	129.371	
	129.341	
	129.341	
	129.371	
	130.322	
	130.358	
	130.358	
	130.522	
	129.929	
	130.350	
	130.522	
	130.633	
	130.687	
	130.647	
	130.609	
	130.642	
	130.724	
	130.835	

PUNTO KILOMÉTRICO : 28+900

CUT: 0.852 m2
 FILL: 7.942 m2



COTA DE REFERENCIA : 122.000 m.

DESIGNED LEVELS	EXISTING LEVELS	OFFSET
	124.801	
	124.801	
	124.800	
	124.811	
	124.843	
	124.851	
	124.886	
	124.884	
	124.879	
	124.922	
	124.922	
	124.962	
	124.962	
	125.061	
	125.061	
	125.357	
	125.592	
	125.957	
	127.036	
	127.036	
	127.055	
	126.446	
	126.464	
	126.466	
	127.136	
	126.450	
	126.434	
	126.255	
	127.055	
	126.021	
	127.036	
	125.739	
	125.536	
	125.490	
	126.286	
	125.542	
	125.559	
	125.564	
	125.562	
	125.586	
	125.600	
	125.615	
	125.632	
	125.650	
	125.650	
	125.710	
	125.729	
	125.742	
	125.774	

PUNTO KILOMÉTRICO : 28+820

CUT: 6.473 m2
 FILL: 1.047 m2



COTA DE REFERENCIA : 125.000 m.

DESIGNED LEVELS	EXISTING LEVELS	OFFSET
	128.203	
	128.179	
	127.849	
	127.650	
	127.551	
	127.545	
	127.686	
	127.755	
	127.788	
	127.898	
	127.856	
	128.079	
	128.215	
	128.553	
	128.697	
	129.302	
	129.321	
	129.199	
	129.192	
	129.224	
	129.225	
	129.402	
	129.197	
	128.975	
	129.321	
	128.844	
	129.302	
	128.611	
	128.500	
	128.599	
	128.410	
	128.385	
	128.410	
	128.640	
	128.640	
	128.871	
	128.871	
	129.001	
	129.020	
	129.055	
	129.138	
	129.169	
	129.207	
	129.245	
	129.310	
	129.310	
	129.404	
	129.464	

PUNTO KILOMÉTRICO : 28+880

CUT: 0.183 m2
 FILL: 24.005 m2



COTA DE REFERENCIA : 121.000 m.

DESIGNED LEVELS	EXISTING LEVELS	OFFSET
	123.474	
	123.454	
	123.431	
	123.417	
	123.419	
	123.413	
	123.429	
	123.469	
	123.499	
	123.552	
	123.750	
	124.036	
	124.235	
	124.804	
	125.306	
	126.459	
	126.509	
	126.528	
	125.725	
	125.835	
	125.809	
	125.845	
	126.609	
	125.845	
	125.857	
	125.665	
	126.528	
	125.549	
	125.213	
	126.509	
	124.673	
	123.926	
	123.683	
	123.670	
	125.175	
	123.799	
	123.810	
	123.807	
	123.813	
	123.859	
	123.866	
	123.947	
	123.991	
	124.007	
	124.025	
	124.038	

PUNTO KILOMÉTRICO : 28+800

CUT: 5.909 m2
 FILL: 0.305 m2



COTA DE REFERENCIA : 124.000 m.

DESIGNED LEVELS	EXISTING LEVELS	OFFSET
	127.466	
	127.475	
	127.401	
	127.161	
	127.010	
	126.984	
	126.984	
	126.816	
	126.912	
	127.020	
	127.142	
	127.264	
	127.296	
	127.345	
	127.476	
	127.857	
	127.679	
	127.822	
	128.116	
	128.451	
	128.214	
	128.254	
	128.272	
	128.236	
	128.162	
	128.162	
	128.075	
	128.451	
	128.433	
	127.783	
	127.727	
	127.779	
	127.896	
	127.913	
	127.415	
	127.415	
	127.905	
	127.947	
	127.953	
	127.953	
	127.925	
	127.943	
	127.999	
	128.110	
	128.154	
	128.162	
	128.230	
	128.271	
	128.291	
	128.310	

PUNTO KILOMÉTRICO : 28+860

CUT: 6.499 m2
 FILL: 6.921 m2



COTA DE REFERENCIA : 128.000 m.

DESIGNED LEVELS	EXISTING LEVELS	OFFSET
130.859	130.859	
130.687	130.687	
130.372	130.372	
130.224	130.224	-16.237
130.087	130.087	
130.220	130.220	
130.459	130.459	
130.549	130.549	
130.787	130.787	-10.368
131.076	131.076	
131.277	131.277	
131.487	131.487	
131.712	131.712	
132.120	132.120	
132.520	132.520	
132.602	132.602	
133.121	133.121	-4.500
133.190	133.190	-3.250
133.026	133.026	
133.176	133.176	
133.195	133.195	
133.205	133.205	
133.213	133.213	
133.271	133.271	0.000
133.138	133.138	
133.072	133.072	
133.190	133.190	3.250
133.026	133.026	4.000
133.171	133.171	
132.449	132.449	
131.937	131.937	
131.734	131.734	7.069
131.703	131.703	
131.716	131.716	9.888
131.744	131.744	
131.736	131.736	
131.868	131.868	
131.924	131.924	
132.043	132.043	
132.099	132.099	
132.223	132.223	
132.323	132.323	
132.385	132.385	
132.489	132.489	
132.616	132.616	
132.922	132.922	

PUNTO KILOMÉTRICO : 28+960

CUT: 10.813 m2
 FILL: 0.000 m2



COTA DE REFERENCIA : 132.000 m.

DESIGNED LEVELS	EXISTING LEVELS	OFFSET
134.819	134.819	
134.874	134.874	
134.921	134.921	
134.937	134.937	
134.972	134.972	
135.001	135.001	
135.063	135.063	
135.121	135.121	
135.167	135.167	
135.174	135.174	
135.192	135.192	-8.504
135.200	135.200	-8.251
135.210	135.210	-7.751
135.210	135.210	
135.330	135.330	
135.403	135.403	
135.577	135.577	
135.698	135.698	
135.729	135.729	-3.250
136.022	136.022	
136.176	136.176	
136.207	136.207	
136.203	136.203	0.000
136.192	136.192	
136.147	136.147	
136.034	136.034	3.250
136.003	136.003	4.000
135.647	135.647	
135.484	135.484	
135.426	135.426	
135.448	135.448	7.721
135.110	135.110	8.021
134.982	134.982	9.221
134.882	134.882	10.553
135.496	135.496	11.166
135.467	135.467	
135.403	135.403	
135.434	135.434	
135.473	135.473	
135.505	135.505	
135.547	135.547	
135.615	135.615	
135.659	135.659	
135.695	135.695	
135.895	135.895	
136.048	136.048	
136.097	136.097	
136.162	136.162	

PUNTO KILOMÉTRICO : 29+020

CUT: 6.828 m2
 FILL: 4.198 m2



COTA DE REFERENCIA : 127.000 m.

DESIGNED LEVELS	EXISTING LEVELS	OFFSET
130.128	130.128	
130.117	130.117	
130.017	130.017	
129.762	129.762	
129.841	129.841	
129.904	129.904	
129.974	129.974	-13.130
129.957	129.957	
130.081	130.081	
130.165	130.165	
130.210	130.210	-8.690
130.292	130.292	
130.513	130.513	
130.709	130.709	
131.283	131.283	
131.708	131.708	-4.000
132.202	132.202	-3.250
132.220	132.220	
132.220	132.220	
132.251	132.251	
132.284	132.284	
132.275	132.275	0.000
132.302	132.302	
132.250	132.250	
132.274	132.274	
132.115	132.115	3.250
132.220	132.220	4.000
131.872	131.872	
131.671	131.671	6.272
131.212	131.212	
131.136	131.136	8.294
131.206	131.206	
131.235	131.235	
131.221	131.221	
131.276	131.276	
131.413	131.413	
131.560	131.560	
131.695	131.695	
131.805	131.805	
132.005	132.005	
132.123	132.123	
132.272	132.272	
132.536	132.536	

PUNTO KILOMÉTRICO : 28+940

CUT: 9.466 m2
 FILL: 0.006 m2



COTA DE REFERENCIA : 130.000 m.

DESIGNED LEVELS	EXISTING LEVELS	OFFSET
132.994	132.994	
133.234	133.234	
133.472	133.472	
133.702	133.702	
133.822	133.822	
133.907	133.907	
134.093	134.093	
134.208	134.208	
134.271	134.271	
134.314	134.314	-10.435
134.360	134.360	-9.924
134.411	134.411	-8.751
134.469	134.469	-7.751
134.520	134.520	
134.617	134.617	
134.929	134.929	-4.000
135.103	135.103	-3.250
135.115	135.115	
135.122	135.122	
135.216	135.216	
135.242	135.242	0.000
135.248	135.248	
135.207	135.207	
135.162	135.162	
135.091	135.091	3.250
134.970	134.970	4.000
134.872	134.872	
134.597	134.597	
134.235	134.235	
134.211	134.211	7.721
134.171	134.171	8.021
134.086	134.086	9.221
134.201	134.201	10.553
134.224	134.224	
134.246	134.246	
134.283	134.283	
134.329	134.329	
134.381	134.381	
134.569	134.569	
134.764	134.764	
134.927	134.927	

PUNTO KILOMÉTRICO : 29+000

CUT: 9.070 m2
 FILL: 2.245 m2



COTA DE REFERENCIA : 127.000 m.

DESIGNED LEVELS	EXISTING LEVELS	OFFSET
128.490	128.490	
128.437	128.437	
128.348	128.348	
128.132	128.132	
128.078	128.078	
128.074	128.074	
128.137	128.137	
128.186	128.186	
128.318	128.318	-11.845
129.309	129.309	
129.556	129.556	
130.258	130.258	-8.048
130.807	130.807	
130.058	130.058	
130.416	130.416	
130.794	130.794	
131.133	131.133	-3.250
131.186	131.186	
131.272	131.272	
131.333	131.333	0.000
131.265	131.265	
131.257	131.257	
131.274	131.274	
131.053	131.053	3.250
131.251	131.251	
130.854	130.854	
130.724	130.724	
130.631	130.631	
130.631	130.631	
130.717	130.717	7.721
130.733	130.733	8.021
130.845	130.845	9.221
130.891	130.891	
130.940	130.940	
131.038	131.038	
131.170	131.170	11.306
131.170	131.170	
131.249	131.249	
131.343	131.343	13.396
131.382	131.382	14.603
131.570	131.570	14.803
131.922	131.922	
132.101	132.101	
132.320	132.320	
132.768	132.768	

PUNTO KILOMÉTRICO : 28+920

CUT: 7.358 m2
 FILL: 4.883 m2



COTA DE REFERENCIA : 128.000 m.

DESIGNED LEVELS	EXISTING LEVELS	OFFSET
131.429	131.429	
131.664	131.664	
130.964	130.964	-17.586
130.818	130.818	
130.660	130.660	
130.761	130.761	
131.009	131.009	
131.258	131.258	
131.588	131.588	
131.717	131.717	
131.853	131.853	
131.974	131.974	-11.043
132.454	132.454	
133.331	133.331	
133.600	133.600	
132.868	132.868	
133.289	133.289	
133.786	133.786	
133.964	133.964	-4.500
134.158	134.158	-3.250
134.159	134.159	
134.213	134.213	
134.249	134.249	0.000
134.248	134.248	
134.242	134.242	
134.118	134.118	
133.910	133.910	3.250
134.140	134.140	4.000
133.846	133.846	
133.758	133.758	
133.601	133.601	6.305
133.076	133.076	
133.084	133.084	
133.114	133.114	8.359
133.174	133.174	
133.272	133.272	
133.319	133.319	
133.354	133.354	
133.426	133.426	
133.464	133.464	
133.559	133.559	
133.672	133.672	
133.878	133.878	
134.006	134.006	

PUNTO KILOMÉTRICO : 28+980

CUT: 69.489 m2
 FILL: 103.874 m2

COTA DE REFERENCIA : 134.000 m.

DESIGNED LEVELS	EXISTING LEVELS	OFFSET
142.597	142.723	
142.977	143.206	
143.387	143.549	
143.909	144.203	
144.354	144.508	
144.882	145.234	
145.389	145.476	
145.672	145.650	
145.650	145.639	
145.624	145.624	
145.608	145.761	
145.761	146.062	
146.470	146.470	
146.639	146.639	
146.687	146.687	
146.515	146.442	
146.376	146.383	
146.383	146.383	
146.455	146.500	
146.496	146.496	
146.489	146.489	
146.447	146.434	
146.390	146.390	
146.303	146.214	-36.986
146.214	146.214	
145.898	145.898	
145.730	145.730	
145.235	145.235	
144.406	144.406	-31.878
143.626	143.626	
145.778	145.778	
145.639	145.639	-30.750
145.449	145.449	-29.628
145.449	145.449	-28.517
145.208	145.208	-27.417
144.917	144.917	-26.332
144.576	144.576	-25.284
144.186	144.186	-24.214
143.748	143.748	-23.186
143.263	143.263	-22.361
142.850	142.850	-21.623
142.494	142.494	-20.118
141.842	141.842	-19.353
141.547	141.547	-18.580
141.273	141.273	-17.800
141.020	141.020	-17.014
140.789	140.789	-16.221
140.579	140.579	-15.432
137.172	137.172	
137.355	137.355	
137.985	137.985	
138.266	138.266	-11.228
139.197	139.197	-10.273
139.542	139.542	-9.221
138.958	138.958	-8.221
139.614	139.614	-7.221
138.839	138.839	-6.221
140.554	140.554	
140.989	140.989	
141.503	141.503	
141.716	141.716	-3.250
141.783	141.783	
139.740	141.804	
141.804	141.804	
141.826	141.826	
141.831	141.831	
141.830	141.830	0.000
139.822	141.842	
141.786	141.786	
139.740	141.786	
139.722	141.536	3.250
141.377	141.536	4.000
141.358	141.358	
141.976	141.976	
138.829	141.976	7.221
138.704	141.976	8.221
138.704	142.155	8.221
138.623	142.350	9.221
142.439	142.439	
142.459	142.459	
142.467	142.467	12.253
140.345	142.474	
142.476	142.476	
142.426	142.426	15.807
142.086	142.086	15.602
142.325	142.325	16.344
142.388	142.388	16.228
142.389	142.389	17.521
142.396	142.396	
142.385	142.385	

PUNTO KILOMÉTRICO : 29+140

CUT: 65.603 m2
 FILL: 4.145 m2

COTA DE REFERENCIA : 136.000 m.

DESIGNED LEVELS	EXISTING LEVELS	OFFSET
141.148	141.148	
141.259	141.259	
141.465	141.465	
141.672	141.672	
141.751	141.751	
141.953	141.953	
142.074	142.074	
142.172	142.172	
142.292	142.292	
142.461	142.461	
142.562	142.562	
142.675	142.675	
142.817	142.817	
142.985	142.985	
143.046	143.046	
143.175	143.175	
143.339	143.339	
143.425	143.425	
143.489	143.489	
143.544	143.544	
143.567	143.567	
143.666	143.666	
143.687	143.687	
143.901	143.901	
144.155	144.155	
144.293	144.293	
144.463	144.463	
144.739	144.739	
144.869	144.869	
145.036	145.036	
145.110	145.110	
145.225	145.225	
145.433	145.433	
145.636	145.636	
145.772	145.772	
145.972	145.972	
146.564	146.564	
147.151	147.151	
147.451	147.451	
147.519	147.519	
147.500	147.500	
147.243	147.243	
146.874	146.874	
146.674	146.674	
145.778	145.778	
145.418	145.418	
145.104	145.104	
144.381	144.381	
144.033	144.033	
143.735	143.735	
143.287	143.287	
142.942	142.942	
142.880	142.880	
142.711	142.711	
142.379	142.379	
141.899	141.899	
141.558	141.558	
140.799	140.799	
140.079	140.079	
139.712	139.712	
139.574	139.574	
139.455	139.455	
139.520	139.520	
139.668	139.668	
139.619	139.619	
139.530	139.530	
139.419	139.419	
140.098	140.098	
138.914	138.914	
140.293	140.293	
140.338	140.338	
138.409	138.409	
140.372	140.372	
138.409	138.409	
140.495	140.495	
140.575	140.575	
140.745	140.745	
141.065	141.065	
141.181	141.181	
139.321	141.181	-3.250
141.204	141.204	
141.207	141.207	
139.402	141.207	0.000
141.181	141.181	
141.148	141.148	
141.084	141.084	
139.321	141.084	3.250
139.302	141.084	4.000
140.950	140.950	
141.008	141.008	
141.151	141.151	
141.337	141.337	
138.409	141.337	7.221
138.409	141.337	8.221
138.409	141.337	9.221
142.005	142.005	
142.093	142.093	
139.896	142.093	12.196
142.000	142.000	
141.961	141.961	
141.884	141.884	
141.921	141.921	15.170
141.921	141.921	15.602
141.921	141.921	16.344
141.921	141.921	16.228
141.921	141.921	17.407
141.908	141.908	
141.912	141.912	
141.845	141.845	

PUNTO KILOMÉTRICO : 29+120

CUT: 59.692 m2
 FILL: 4.297 m2

COTA DE REFERENCIA : 135.000 m.

DESIGNED LEVELS	EXISTING LEVELS	OFFSET
139.900	139.900	
140.201	140.201	
140.434	140.434	
140.550	140.550	
140.870	140.870	
140.902	140.902	
140.924	140.924	
140.863	140.863	
140.733	140.733	
140.696	140.696	
140.673	140.673	
140.760	140.760	
141.103	141.103	
141.281	141.281	
141.558	141.558	
142.130	142.130	
142.425	142.425	
142.600	142.600	
142.694	142.694	
142.865	142.865	
142.935	142.935	
142.996	142.996	
143.173	143.173	
143.585	143.585	
143.766	143.766	
143.992	143.992	
144.178	144.178	
144.253	144.253	
144.400	144.400	
144.529	144.529	
144.657	144.657	
144.753	144.753	
144.885	144.885	
144.977	144.977	
145.098	145.098	
145.327	145.327	
145.550	145.550	
145.793	145.793	
145.971	145.971	
146.165	146.165	
146.160	146.160	
146.239	146.239	
146.134	146.134	
145.938	145.938	
145.696	145.696	
144.995	144.995	
144.494	144.494	
143.914	143.914	
143.746	143.746	
143.594	143.594	
143.413	143.413	
143.374	143.374	
143.370	143.370	
143.319	143.319	
143.258	143.258	
143.008	143.008	
142.432	142.432	
141.490	141.490	
141.013	141.013	
140.427	140.427	
139.232	139.232	
138.982	138.982	
138.856	138.856	
138.735	138.735	
138.534	138.534	
138.382	138.382	
138.702	138.702	
138.146	138.146	
138.056	138.056	
137.909	137.909	
137.784	137.784	
137.684	137.684	
137.586	137.586	
137.509	137.509	
138.512	138.512	
138.667	138.667	
138.537	138.537	
138.037	138.037	
138.802	138.802	
140.241	140.241	-4.000
138.821	138.821	-3.250
140.349	140.349	
140.378	140.378	
140.401	140.401	
140.359	140.359	
138.902	140.359	0.000
140.272	140.272	
138.821	140.272	3.250
138.802	140.272	4.000
140.128	140.128	
140.130	140.130	
140.698	140.698	
137.909	140.698	7.221
137.784	140.698	8.221
137.784	140.698	9.221
137.909	140.698	9.221
141.605	141.605	
141.555	141.555	
139.372	141.555	12.146
141.478	141.478	
141.463	141.463	
141.435	141.435	
140.834	141.435	15.070
141.052	141.410	15.602
141.329	141.374	16.228
141.329	141.354	16.344
141.362	141.362	17.306
141.283	141.283	
141.260	141.260	

PUNTO KILOMÉTRICO : 29+100

CUT: 28.835 m2
 FILL: 212.451 m2

COTA DE REFERENCIA : 134.000 m.

DESIGNED LEVELS	EXISTING LEVELS	OFFSET
147.832	147.842	
147.842	147.847	
147.852	147.852	
147.866	147.866	
147.880	147.880	
147.849	147.849	
147.845	147.845	
147.890	147.890	
147.937	147.937	
147.953	147.953	
148.006	148.006	
148.001	148.001	
147.921	147.921	
147.839	147.839	
147.800	147.800	
147.780	147.780	
147.753	147.753	
147.713	147.713	
147.686	147.686	
147.656	147.656	
147.600	147.600	
147.701	147.701	
147.725	147.725	
147.878	147.878	
148.046	148.046	
148.270	148.270	
148.511	148.511	
148.511	148.511	
148.149	148.149	
149.591	149.591	
149.829	149.829	
150.055	150.055	
150.209	150.209	
150.239	150.239	
149.963	149.963	
149.813	149.813	
149.298	149.298	
148.798	148.798	
148.432	148.432	
149.639	149.639	
149.500	149.500	
149.310	149.310	
144.442	144.442	
149.069	149.069	
148.778	148.778	
141.393	141.393	
148.437	148.437	
140.650	140.650	
148.047	148.047	
147.609	147.609	
147.124	147.124	
137.371	137.371	
137.034	137.034	
136.689	136.689	
136.522	136.522	
136.396	136.396	
136.284	136.284	
136.276	136.276	
143.664	143.664	
143.307	143.307	
142.971	142.971	
136.302	136.302	
142.655	142.655	
142.360	142.360	
142.650	142.650	
141.833	141.833	
141.833	141.833	
141.392	141.392	
136.363	136.363	
136.367	136.367	
136.365	136.365	
136.362	136.362	
136.338	136.338	
136.330	136.330	
139.642	139.642	
139.371	139.371	
139.642	139.642	
136.316	136.316	
136.351	136.351	
136.362	136.362	
140.510	140.510	
140.510	140.510	
140.579	140.579	
136.592	136.592	
137.002	137.002	
140.660	140.660	
138.779	138.779	
140.832	140.832	
140.579	140.579	
141.568	141.568	
142.452	142.452	
142.559	142.559	
142.630	142.630	
139.667	139.667	
139.667	139.667	
142.702	142.702	
139.667	139.667	
142.723	142.723	
142.681	142.681	
142.677	142.677	
141.683	141.683	
143.065	143.065	
143.898	143.898	
143.898	143.898	
144.093	144.093	
144.148	144.148	
144.221	144.221	
144.226	144.226	

PUNTO KILOMÉTRICO : 29+260

CUT: 61.168 m2
 FILL: 243.019 m2

COTA DE REFERENCIA : 133.000 m.

DESIGNED LEVELS	EXISTING LEVELS	OFFSET
147.876	147.876	
147.904	147.904	
147.927	147.927	
147.961	147.961	
147.987	147.987	
148.030	148.030	
148.033	148.033	
148.042	148.042	
148.042	148.042	
148.040	148.040	
148.032	148.032	
148.035	148.035	
148.048	148.048	
148.092	148.092	
148.111	148.111	
148.138	148.138	
148.171	148.171	
148.266	148.266	
148.360	148.360	
148.702	148.702	
148.858	148.858	
148.975	148.975	
149.010	149.010	
149.083	149.083	
149.132	149.132	
149.324	149.324	
149.802	149.802	
150.224	150.224	
150.457	150.457	
150.953	150.953	
151.072	151.072	
151.099	151.099	
151.109	151.109	
151.104	151.104	
150.661	150.661	
150.054	150.054	
149.208	149.208	
148.347	148.347	
150.484	150.484	
150.345	150.345	
147.601	147.601	
150.155	150.155	
144.764	144.764	
149.914	149.914	
149.623	149.623	
149.282	149.282	
148.892	148.892	
148.792	148.792	
148.454	148.454	
147.969	147.969	
147.735	147.735	
135.675	135.675	
135.609	135.609	
135.538	135.538	
135.548	135.548	
135.510	135.510	
135.505	135.505	
143.749	143.749	
143.392	143.392	
143.392	143.392	
142.740	142.740	
142.571	142.571	
142.445	142.445	
142.171	142.171	
141.919	141.919	
141.687	141.687	
141.478	141.478	
135.572	135.572	
135.554	135.554	
135.813	135.813	
136.364	136.364	
136.625	136.625	
139.728	139.728	
139.667	139.667	
139.667	139.667	
138.381	138.381	
139.587	139.587	
140.099	140.099	
140.979	140.979	
140.620	140.620	
141.398	141.398	
140.639	140.639	
142.056	142.056	
142.507	142.507	
142.720	142.720	
142.676	142.676	
142.828	142.828	
140.639	140.639	
142.948	142.948	
140.620	140.620	
143.003	143.003	
143.052	143.052	
143.075	143.075	
139.728	139.728	
139.667	139.667	
139.667	139.667	
143.138	143.138	
143.148	143.148	
143.152	143.152	
143.414	143.414	
143.516	143.516	
143.749	143.749	
144.167	144.167	
142.385	142.385	
144.482	144.482	
145.033	145.033	
145.425	145.425	
145.653	145.653	
145.723	145.723	
145.949	145.949	

PUNTO KILOMÉTRICO : 29+240

CUT: 73.128 m2
 FILL: 285.377 m2

COTA DE REFERENCIA : 133.000 m.

DESIGNED LEVELS	EXISTING LEVELS	OFFSET
147.484	147.484	
147.539	147.539	
147.611	147.611	
147.717	147.717	
147.763	147.763	
147.913	147.913	
148.077	148.077	
148.266	148.266	
148.366	148.366	
148.414	148.414	
148.522	148.522	
148.657	148.657	
148.770	148.770	
148.865	148.865	
149.045	149.045	
149.161	149.161	
149.240	149.240	
149.284	149.284	
149.413	149.413	
149.560	149.560	
149.638	149.638	
149.831	149.831	
150.130	150.130	
150.571	150.571	
150.757	150.757	
151.192	151.192	
151.366	151.366	
151.535	151.535	
151.598	151.598	
151.717	151.717	
151.742	151.742	
151.760	151.760	
151.723	151.723	
151.665	151.665	
151.411	151.411	
151.411	151.411	
150.730	150.730	
149.934	149.934	
147.272	147.272	
151.105	151.105	
144.880	144.880	
150.966	150.966	
142.717	142.717	
150.776	150.776	
150.539	150.539	
150.244	150.244	
149.903	149.903	
149.513	149.513	
149.075	149.075	
148.589	148.589	
148.564	148.564	
135.560	135.560	
135.581	135.581	
135.580	135.580	
135.564	135.564	
135.561	135.561	
135.553	135.553	
135.544	135.544	
135.520	135.520	
143.729	143.729	
143.494	143.494	
143.373	143.373	
143.373	143.373	
142.721	142.721	
142.426	142.426	
142.480	142.480	
142.152	142.152	
141.889	141.889	
141.889	141.889	
141.458	141.458	
135.487	135.487	
135.578	135.578	
135.691	135.691	
136.147	136.147	
136.414	136.414	
136.657	136.657	
137.078	137.078	
137.673	137.673	
138.481	138.481	
138.681	138.681	
138.708	138.708	
138.708	138.708	
139.219	139.219	
139.819	139.819	
140.470	140.470	
140.935	140.935	
140.601	140.601	
141.802	141.802	
140.619	140.619	
142.008	142.008	
142.563	142.563	
140.701	140.701	
142.961	142.961	
143.009	143.009	
143.106	143.106	
140.619	140.619	
140.601	140.601	
143.160	143.160	
143.174	143.174	
143.166	143.166	
143.148	143.148	
139.708	139.708	
139.667	139.667	
139.667	139.667	
143.133	143.133	
143.145	143.145	
143.490	143.490	
143.730	143.730	
144.008	144.008	
144.272	144.272	
144.513	144.513	
144.573	144.573	
144.601	144.601	
144.642	144.642	
144.470	144.470	
144.665	144.665	
144.579	144.579	
144.653	144.653	

PUNTO KILOMÉTRICO : 29+220

CUT: 24.465 m2
 FILL: 39.253 m2

COTA DE REFERENCIA : 134.000 m.

DESIGNED LEVELS	EXISTING LEVELS	OFFSET
150.109	150.094	
149.220	149.214	
150.069	150.069	
149.246	149.257	
149.957	149.924	
149.859	149.806	
149.748	149.694	
149.623	149.623	
149.509	149.509	
149.358	149.358	
149.251	149.251	
149.187	149.187	
149.072	149.072	
148.987	148.987	
148.937	148.937	
148.788	148.788	
148.612	148.612	
148.315	148.315	
148.065	148.065	
147.922	147.922	
147.771	147.771	
147.621	147.621	
147.509	147.509	
147.408	147.408	
147.277	147.277	
147.077	147.077	
146.781	146.781	
146.744	146.744	
146.650	146.650	
146.507	146.507	
146.400	146.400	
146.450	146.450	
146.591	146.591	
146.691	146.691	
146.817	146.817	
146.876	146.876	
146.884	146.884	
146.968	146.968	
147.034	147.034	
147.069	147.069	
147.118	147.118	
147.073	147.073	
147.007	147.007	
146.837	146.837	
146.083	146.083	-32.302
146.028	146.028	-31.173
145.839	145.839	-30.052
145.598	145.598	-28.941
145.080	145.080	-27.841
145.306	144.792	-26.756
144.965	144.176	-25.688
144.576	143.765	-24.638
144.137	143.315	-23.610
143.652	142.769	-22.361
143.028	142.169	-21.823
142.571	141.908	-20.623
142.019	141.633	-20.118
141.724	141.437	-19.353
141.450	141.324	-18.580
141.198	141.160	-17.800
140.986	140.963	-17.014
140.757	140.757	-16.221
140.236	140.236	
139.958	139.958	
137.587	137.587	
137.358	137.358	
136.866	136.866	-8.221
136.882	136.882	-8.221
136.703	136.703	-7.721
136.576	136.576	
136.571	136.571	
136.590	136.590	-4.000
136.646	136.646	-3.250
136.705	136.705	
136.840	136.840	
136.915	136.915	
137.240	137.240	0.000
136.264	136.264	
136.018	136.018	
135.918	135.918	3.250
135.899	135.899	4.000
140.027	140.027	
140.162	140.162	
140.138	140.138	
140.124	140.124	7.721
140.156	140.156	8.021
139.882	139.882	8.021
139.007	139.007	9.221
140.154	140.154	
140.215	140.215	
140.301	140.301	11.548
139.898	139.898	
140.359	140.359	
140.170	140.170	13.877
140.320	140.320	14.800
140.212	140.212	15.600
140.016	140.016	
139.878	139.878	
139.587	139.587	
139.289	139.289	

PUNTO KILOMÉTRICO : 29+320

CUT: 37.086 m2
 FILL: 123.407 m2

COTA DE REFERENCIA : 134.000 m.

DESIGNED LEVELS	EXISTING LEVELS	OFFSET
143.207	143.207	
143.220	143.220	
143.214	143.214	
149.246	149.246	
149.257	149.257	
149.277	149.277	
149.294	149.294	
149.307	149.307	
149.303	149.303	
149.288	149.288	
149.288	149.288	
149.281	149.281	
149.325	149.325	
149.367	149.367	
149.411	149.411	
149.514	149.514	
149.576	149.576	
149.617	149.617	
149.649	149.649	
149.639	149.639	
149.584	149.584	
149.445	149.445	
149.337	149.337	
148.222	148.222	
148.937	148.937	
148.785	148.785	
148.462	148.462	
148.184	148.184	
148.054	148.054	
147.919	147.919	
147.817	147.817	
147.617	147.617	
147.517	147.517	
147.470	147.470	
147.388	147.388	
147.350	147.350	
147.644	147.644	
147.852	147.852	
148.035	148.035	
148.235	148.235	
148.335	148.335	
148.525	148.525	
148.671	148.671	
148.718	148.718	
148.724	148.724	
148.593	148.593	-38.608
148.446	148.446	
148.183	148.183	
148.365	148.365	-36.097
148.226	148.226	-34.968
148.036	148.036	-33.847
147.795	147.795	-32.735
147.504	147.504	-31.636
147.163	147.163	-30.551
146.773	146.773	-29.483
146.335	146.335	-28.433
145.850	145.850	-27.404
141.112	141.112	
140.894	140.894	
140.467	140.467	
140.219	140.219	
140.339	140.339	
143.328	143.328	-22.361
142.972	142.972	-21.823
142.571	142.571	-21.823
142.320	142.320	-20.118
142.025	142.025	-19.353
141.751	141.751	-18.580
141.498	141.498	-17.800
141.267	141.267	-17.014
141.057	141.057	-16.221
137.215	137.215	
136.821	136.821	
136.516	136.516	
136.396	136.396	
136.173	136.173	
136.152	136.152	
136.307	136.307	-8.221
136.182	136.182	-8.221
136.102	136.102	-7.721
136.007	136.007	-7.721
136.089	136.089	
136.059	136.059	
136.031	136.031	
136.018	136.018	
140.218	140.218	-3.250
136.199	136.199	
136.423	136.423	0.000
136.741	136.741	0.000
140.300	140.300	
136.054	136.054	
136.885	136.885	3.250
140.218	140.218	4.000
140.687	140.687	
140.835	140.835	
140.896	140.896	7.721
140.955	140.955	8.021
141.049	141.049	8.021
141.098	141.098	9.221
141.121	141.121	
141.121	141.121	11.621
141.161	141.161	
141.226	141.226	14.020
141.098	141.098	14.800
141.149	141.149	15.600
140.981	140.981	
140.736	140.736	
140.533	140.533	
140.355	140.355	

PUNTO KILOMÉTRICO : 29+300

CUT: 30.730 m2
 FILL: 204.073 m2

COTA DE REFERENCIA : 133.000 m.

DESIGNED LEVELS	EXISTING LEVELS	OFFSET
146.154	146.154	
146.150	146.150	
146.217	146.217	
146.320	146.320	
146.433	146.433	
146.524	146.524	
146.726	146.726	
146.806	146.806	
146.916	146.916	
147.015	147.015	
146.958	146.958	
146.903	146.903	
146.865	146.865	
146.857	146.857	
146.910	146.910	
146.984	146.984	
146.988	146.988	
146.988	146.988	
146.824	146.824	
146.717	146.717	
146.521	146.521	
146.334	146.334	
146.198	146.198	
147.964	147.964	
147.946	147.946	
147.856	147.856	
147.828	147.828	
147.747	147.747	
147.775	147.775	
146.205	146.205	
146.960	146.960	
146.960	146.960	
146.095	146.095	
146.310	146.310	
149.406	149.406	
149.408	149.408	-42.711
149.268	149.268	
149.128	149.128	
148.582	148.582	
148.075	148.075	
147.725	147.725	
146.803	146.803	-36.984
148.879	148.879	
148.740	148.740	-35.856
148.550	148.550	-34.734
148.309	148.309	-33.623
148.036	148.036	-32.523
148.018	148.018	
147.677	147.677	-31.438
147.287	147.287	-30.370
146.849	146.849	-29.320
146.353	146.353	-28.292
146.364	146.364	
138.141	138.141	
137.889	137.889	
137.644	137.644	
137.439	137.439	
137.301	137.301	
143.624	143.624	-27.611
143.167	143.167	-27.173
142.831	142.831	-26.059
142.515	142.515	-25.125
142.220	142.220	-24.368
141.946	141.946	-23.683
141.693	141.693	-23.060
141.439	141.439	-22.499
141.252	141.252	-21.999
135.925	135.925	
135.885	135.885	
135.730	135.730	
135.688	135.688	
135.647	135.647	-9.471
135.653	135.653	-8.971
135.688	135.688	-8.471
135.502	135.502	-7.971
135.713	135.713	
135.734	135.734	
135.754	135.754	
135.774	135.774	
140.320	140.320	-4.600
140.439	140.439	-3.250
135.861	135.861	
135.951	135.951	
136.057	136.057	0.000
136.173	136.173	
140.520	140.520	0.000
137.444	137.444	3.250
140.439	140.439	4.000
140.243	140.243	
140.817	140.817	
141.288	141.288	
141.682	141.682	7.721
141.874	141.874	8.021
141.945	141.945	8.021
139.527	139.527	9.221
141.994	141.994	
142.007	142.007	
142.031	142.031	12.759
142.060	142.060	
142.077	142.077	
142.116	142.116	
141.886	141.886	16.097
141.685	141.685	16.937
141.442	141.442	17.878
142.039	142.039	
142.260	142.260	

PUNTO KILOMÉTRICO : 29+280

CUT: 95.164 m2
 FILL: 2.361 m2

COTA DE REFERENCIA : 135.000 m.

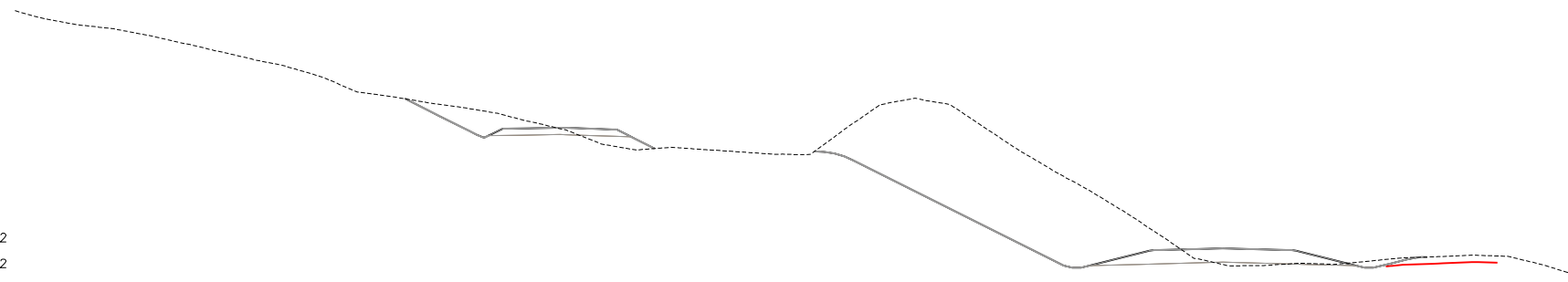

DESIGNED LEVELS	EXISTING LEVELS	OFFSET
152.029	152.029	
151.857	151.857	
151.685	151.685	
151.575	151.575	
151.446	151.446	
151.350	151.350	
151.134	151.134	
150.969	150.969	
150.823	150.823	
150.628	150.628	
150.433	150.433	
150.023	150.023	
149.753	149.753	
149.547	149.547	
149.239	149.239	
149.013	149.013	
148.723	148.723	
148.550	148.550	
148.029	148.029	
147.687	147.687	
147.539	147.539	
147.416	147.416	
147.299	147.299	
147.173	147.173	
147.008	147.008	
146.763	146.763	
146.545	146.545	
146.439	146.439	
146.095	146.095	
144.083	144.083	
144.050	144.050	
144.070	144.070	
144.251	144.251	
144.061	144.061	
144.219	144.219	
143.948	143.948	
143.723	143.723	
146.275	146.275	
146.949	146.949	
147.096	147.096	
147.204	147.204	
147.218	147.218	
147.018	147.018	
146.806	146.806	
140.674	140.674	
145.606	145.606	
144.450	144.450	
144.083	144.083	
143.382	143.382	
142.709	142.709	
142.406	142.406	
141.976	141.976	
141.361	141.361	
140.747	140.747	
140.266	140.266	
139.425	139.425	
138.537	138.537	
138.281	138.281	
138.011	138.011	
137.686	137.686	
138.619	138.619	
137.646	137.646	
138.537	138.537	
137.724	137.724	
137.739	137.739	
137.695	137.695	
137.781	137.781	
137.875	137.875	
137.501	137.501	
137.004	137.004	
137.757	137.757	
138.076	138.076	
137.969	137.969	
138.095	138.095	
138.078	138.078	
138.126	138.126	
138.151	138.151	
138.226	138.226	
138.170	138.170	
137.788	137.788	
137.484	137.484	
137.274	137.274	

PUNTO KILOMÉTRICO : 29+380

CUT: 36.747 m2
 FILL: 0.199 m2

COTA DE REFERENCIA : 135.000 m.

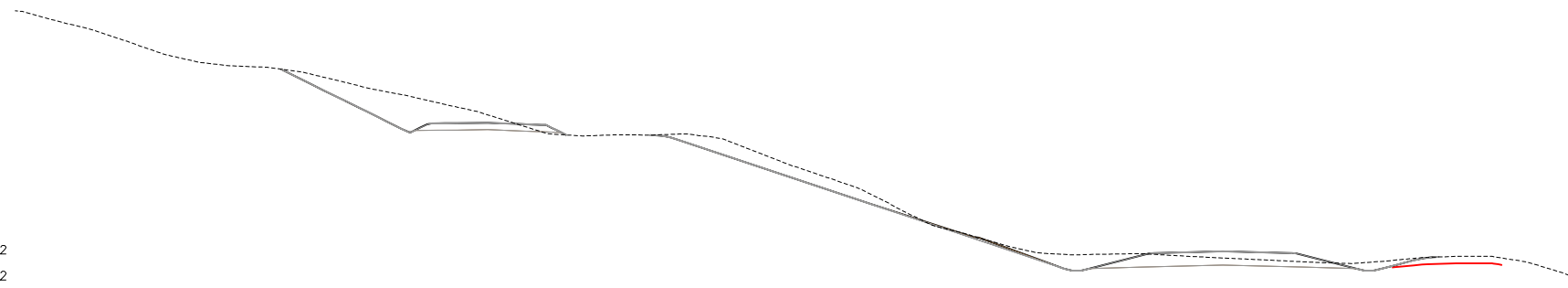

DESIGNED LEVELS	EXISTING LEVELS	OFFSET
152.978	152.978	
152.480	152.480	
152.322	152.322	
152.169	152.169	
151.973	151.973	
151.637	151.637	
151.308	151.308	
151.052	151.052	
150.803	150.803	
150.485	150.485	
150.094	150.094	
150.004	150.004	
149.880	149.880	
149.813	149.813	
148.722	148.722	
148.529	148.529	
148.281	148.281	
148.016	148.016	
148.880	148.880	
148.682	148.682	
148.470	148.470	
148.143	148.143	
147.978	147.978	
147.637	147.637	
147.247	147.247	
147.038	147.038	
146.853	146.853	
146.608	146.608	
146.273	146.273	
145.970	145.970	
145.911	145.911	
145.872	145.872	
145.844	145.844	
145.901	145.901	
145.896	145.896	
145.887	145.887	
145.827	145.827	
145.830	145.830	
145.951	145.951	
145.759	145.759	
145.672	145.672	
145.256	145.256	
144.892	144.892	
144.632	144.632	
144.313	144.313	
143.994	143.994	
143.406	143.406	
143.228	143.228	
142.561	142.561	
141.898	141.898	
141.659	141.659	
141.314	141.314	
141.057	141.057	
140.861	140.861	
140.380	140.380	
140.153	140.153	
139.928	139.928	
139.958	139.958	
139.711	139.711	
139.447	139.447	
139.096	139.096	
139.036	139.036	
138.665	138.665	
138.665	138.665	
138.665	138.665	
138.665	138.665	
138.996	138.996	
139.019	139.019	
139.077	139.077	
139.059	139.059	
139.078	139.078	
139.078	139.078	
139.159	139.159	
138.774	138.774	
138.712	138.712	
138.623	138.623	
139.078	139.078	
138.539	138.539	
138.490	138.490	
138.452	138.452	
138.519	138.519	
138.665	138.665	
138.665	138.665	
138.665	138.665	
138.423	138.423	
138.679	138.679	
138.679	138.679	
138.607	138.607	
138.629	138.629	
138.866	138.866	
138.866	138.866	
138.866	138.866	
138.637	138.637	
138.537	138.537	
138.306	138.306	
137.921	137.921	

PUNTO KILOMÉTRICO : 29+360

CUT: 23.561 m2
 FILL: 1.476 m2

COTA DE REFERENCIA : 136.000 m.

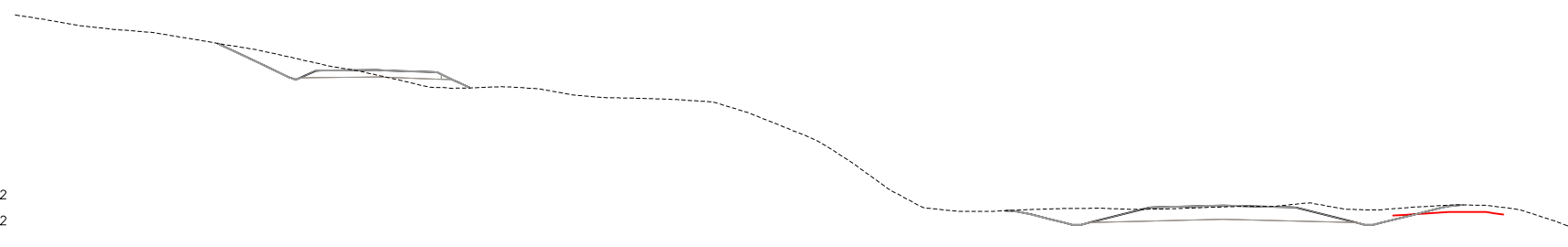

DESIGNED LEVELS	EXISTING LEVELS	OFFSET
150.594	150.594	
150.410	150.410	
150.318	150.318	
150.122	150.122	
150.021	150.021	
149.897	149.897	
149.798	149.798	
149.738	149.738	
149.695	149.695	
149.577	149.577	
149.299	149.299	
149.172	149.172	
148.919	148.919	
148.380	148.380	
148.189	148.189	
147.906	147.906	
147.629	147.629	
147.331	147.331	
147.123	147.123	
146.871	146.871	
146.449	146.449	
146.386	146.386	
146.407	146.407	
146.456	146.456	
146.487	146.487	
146.473	146.473	
146.393	146.393	
146.349	146.349	
146.147	146.147	
146.007	146.007	
145.855	145.855	
145.830	145.830	
145.812	145.812	
145.772	145.772	
145.633	145.633	
145.701	145.701	
145.537	145.537	
145.141	145.141	
144.955	144.955	
144.194	144.194	
143.935	143.935	
143.341	143.341	
142.658	142.658	
141.931	141.931	
140.907	140.907	
140.415	140.415	
139.484	139.484	
139.279	139.279	
139.281	139.281	
139.275	139.275	
139.281	139.281	
139.335	139.335	
139.279	139.279	
139.383	139.383	
139.402	139.402	
138.897	138.897	
139.430	139.430	
138.626	138.626	
138.626	138.626	
138.626	138.626	
138.626	138.626	
139.460	139.460	
139.402	139.402	
139.399	139.399	
139.416	139.416	
139.421	139.421	
139.538	139.538	
139.463	139.463	
139.499	139.499	
139.619	139.619	
139.555	139.555	
139.569	139.569	
139.538	139.538	
139.781	139.781	
139.687	139.687	
139.510	139.510	
139.401	139.401	
139.375	139.375	
138.626	138.626	
138.626	138.626	
138.626	138.626	
138.626	138.626	
139.435	139.435	
139.480	139.480	
139.061	139.061	
139.495	139.495	
139.639	139.639	
139.607	139.607	
139.644	139.644	
139.578	139.578	
139.450	139.450	
139.063	139.063	
138.694	138.694	

PUNTO KILOMÉTRICO : 29+340

CUT: 46.906 m2
 FILL: 3.381 m2

COTA DE REFERENCIA : 133.000 m.

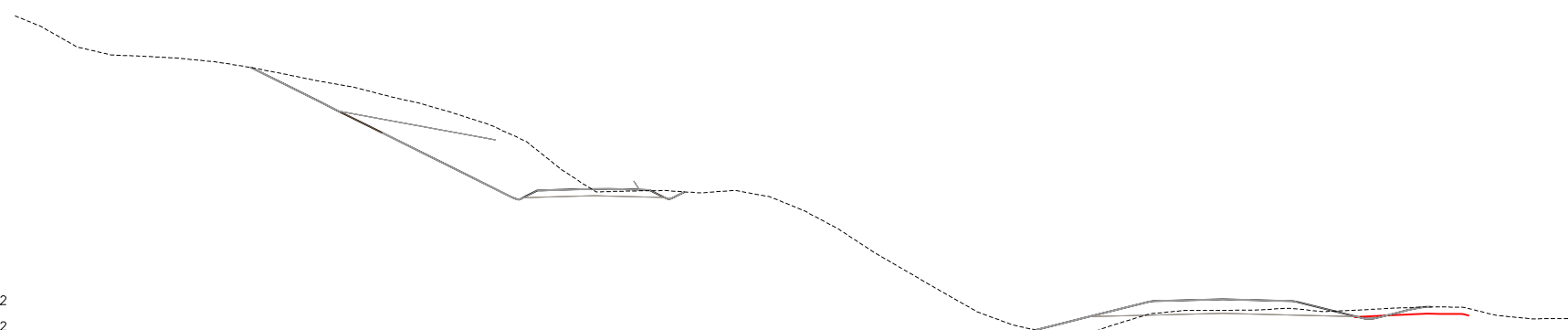

DESIGNED LEVELS	EXISTING LEVELS	OFFSET
153.181	152.887	
151.919	151.919	
151.584	151.443	
151.154	151.364	
151.300	151.245	
151.137	151.045	
150.846	150.733	
150.612	150.445	
150.246	150.002	
149.876	149.876	
149.548		
149.054		
148.537		
148.110		
147.867		
147.348		
146.730		
146.406		
145.459		
144.805		
144.126		
143.517		
143.546		
143.568		
143.582		
143.589		
143.558		
143.494		
143.489		
143.569		
143.216		
142.902		
142.375		
141.488		
141.167		
140.311		
139.759		
139.211		
138.482		
138.675		
137.716		
137.084		
136.576		
136.185		
135.839		
135.551	135.523	-10.849
135.376		
135.327		
135.233		
135.340	136.348	-7.550
135.742		
135.957		
136.483	137.198	-4.000
136.660	137.217	-3.250
136.664	137.298	0.000
136.672		
136.690		
136.767	137.217	3.250
136.725	137.198	4.000
136.645		
136.594		
136.628		
136.681	136.800	6.721
136.731	136.800	6.641
136.786	136.511	8.644
136.821	136.716	10.042
136.867	136.716	10.864
136.865	136.828	11.465
136.853	136.865	12.076
136.720		
136.477		
136.328		
136.201		
136.198		

PUNTO KILOMÉTRICO : 29+420

CUT: 12.763 m2
 FILL: 8.628 m2

COTA DE REFERENCIA : 134.000 m.

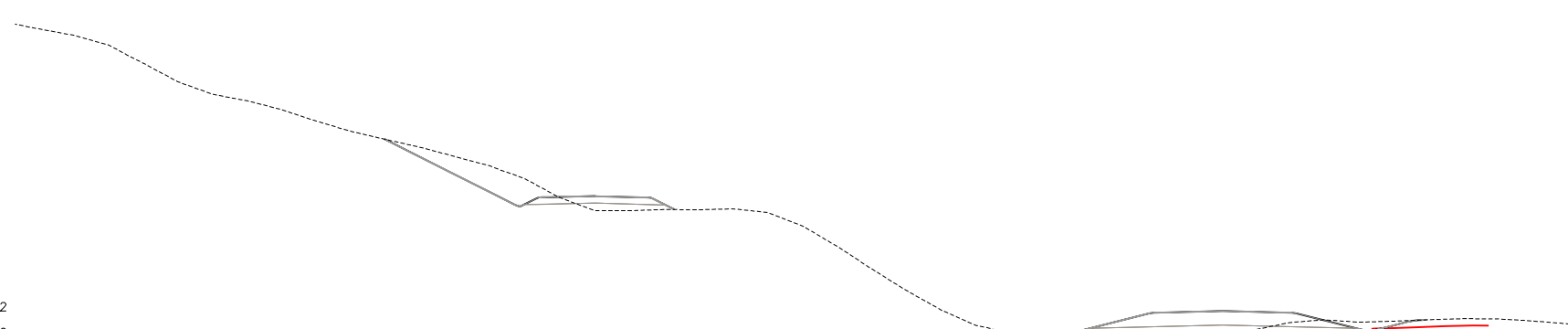

DESIGNED LEVELS	EXISTING LEVELS	OFFSET
154.390	154.269	
154.059	153.793	
153.602	153.409	
152.830	152.369	
151.742	151.288	
151.038	150.768	
150.463	150.235	
150.113	150.113	
149.661	149.476	
148.941		
148.498		
148.296		
148.060		
147.724		
147.649		
147.476		
147.196		
146.939		
146.615		
146.403		
146.157		
145.859		
145.433		
144.493		
143.819		
143.819		
143.867		
143.876		
143.867		
143.865		
143.896		
143.919		
143.812		
143.703		
143.206		
142.917		
142.573		
142.015		
141.485		
140.309		
139.150		
138.177		
137.924		
137.054		
136.847		
136.723		
136.601		
136.531	136.466	-9.801
136.430		
136.347		
136.303	137.179	-7.025
136.259		
136.236		
136.332		
136.444	137.917	-3.250
136.552		
136.583	137.998	0.000
136.687		
136.983		
137.233	137.917	3.250
137.390	137.898	4.000
137.445		
137.498		
137.440		
137.360	137.800	6.721
137.381	136.800	8.644
137.412	137.175	9.688
137.442	137.344	10.575
137.478	137.483	11.786
137.515	137.483	11.786
137.547		
137.559		
137.548		
137.494		
137.438		
137.283		

PUNTO KILOMÉTRICO : 29+400

CUT: 71.901 m2
 FILL: 0.001 m2

COTA DE REFERENCIA : 131.000 m.

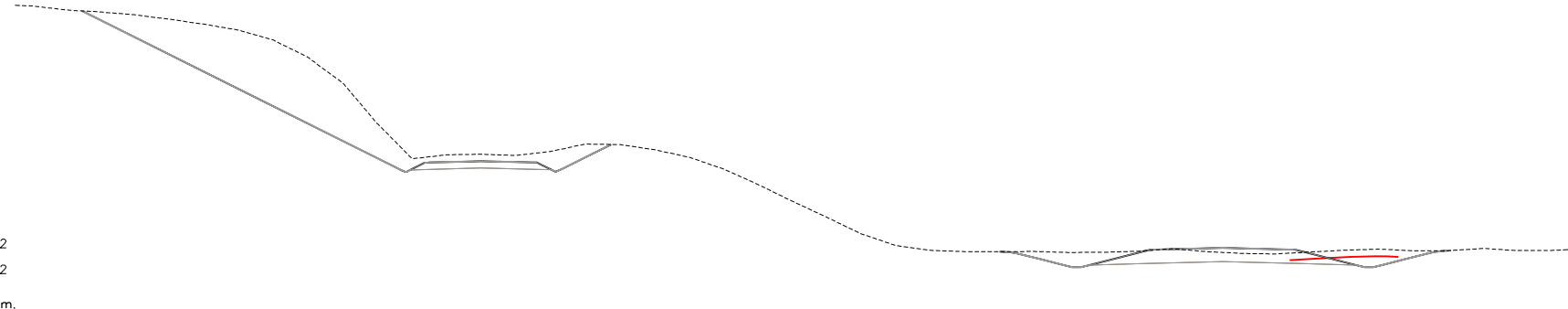

DESIGNED LEVELS	EXISTING LEVELS	OFFSET
148.972	148.972	
148.741	148.741	
148.621	148.621	
148.453	148.453	
148.196	148.196	
147.906	147.906	
147.549	147.549	
146.943	146.943	
145.933	145.933	
144.438	144.438	
142.122	142.122	
140.152	140.152	
140.379	140.379	
140.400	140.400	
140.341	140.341	
140.574	140.574	
141.001	141.001	
140.967	140.967	
140.664	140.664	
140.227	140.227	
139.530	139.530	
138.626	138.626	
137.644	137.644	
136.707	136.707	
135.762	135.762	
135.107	135.107	
134.842	134.842	
134.769	134.769	
134.775	134.775	-12.933
134.774	134.774	-11.720
134.624	134.624	-10.471
134.312	134.312	-9.221
134.000	134.000	-8.221
133.875	133.875	-7.721
134.000	134.000	
134.912	134.912	-3.250
134.928	134.928	
134.795	134.795	0.000
134.762	134.762	
134.690	134.690	
134.666	134.666	
134.646	134.646	3.250
134.658	134.658	
134.912	134.912	
134.735	134.735	
134.767	134.767	
134.843	134.843	6.721
134.870	134.870	8.221
134.910	134.910	8.221
134.908	134.908	
134.830	134.830	10.594
134.824	134.824	11.966
134.798	134.798	12.568
134.851	134.851	13.179
134.834	134.834	
134.942	134.942	
134.857	134.857	
134.846	134.846	
134.841	134.841	
134.866	134.866	

PUNTO KILOMÉTRICO : 29+480

CUT: 115.694 m2
 FILL: 0.023 m2

COTA DE REFERENCIA : 132.000 m.

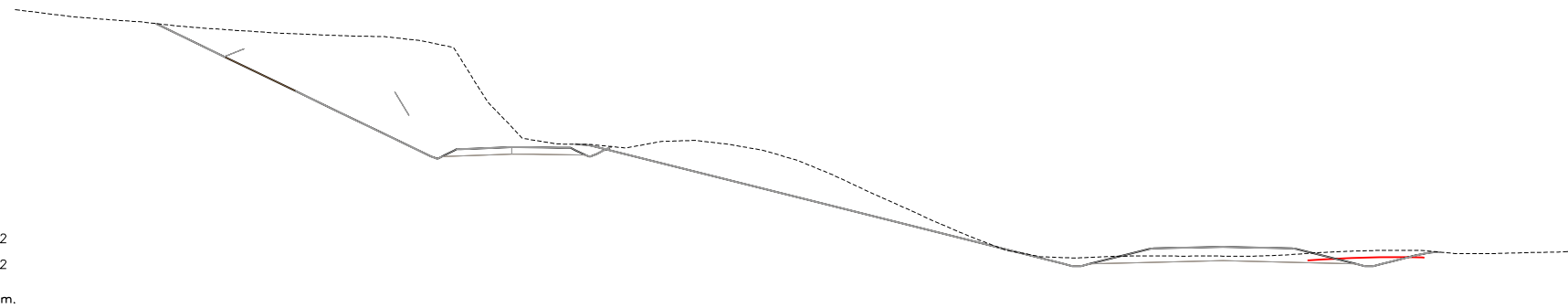

DESIGNED LEVELS	EXISTING LEVELS	OFFSET
149.312	149.312	
149.067	149.067	
148.904	148.904	
148.749	148.749	
148.572	148.572	
148.522	148.522	
148.403	148.403	
148.367	148.367	
148.227	148.227	
148.152	148.152	
148.103	148.103	
148.053	148.053	
148.020	148.020	
147.964	147.964	
147.950	147.950	
147.937	147.937	
147.853	147.853	
147.784	147.784	
147.713	147.713	
147.456	147.456	
147.309	147.309	
145.438	145.438	
144.143	144.143	
143.000	143.000	
142.041	142.041	
141.876	141.876	
141.715	141.715	
141.696	141.696	-37.529
141.679	141.679	-36.326
141.570	141.570	-36.326
141.481	141.481	
141.698	141.698	
141.856	141.856	
141.897	141.897	
141.910	141.910	
141.834	141.834	
141.768	141.768	
141.696	141.696	
141.570	141.570	
141.446	141.446	
141.334	141.334	
141.168	141.168	
140.998	140.998	
140.738	140.738	
140.522	140.522	
140.117	140.117	-22.774
139.701	139.701	
139.174	139.174	
138.797	138.797	
138.245	138.245	
137.933	137.933	
137.380	137.380	
137.003	137.003	
136.252	136.252	
135.540	135.540	
135.185	135.185	
134.770	134.770	-9.221
134.645	134.645	-8.221
134.770	134.770	-7.721
135.125	135.125	
135.204	135.204	
135.238	135.238	-4.000
135.663	135.663	-3.250
135.662	135.662	
135.220	135.220	0.000
135.222	135.222	
135.212	135.212	
135.222	135.222	
135.262	135.262	3.250
135.303	135.303	4.000
135.386	135.386	
135.438	135.438	
135.485	135.485	
135.522	135.522	6.721
135.522	135.522	8.221
135.546	135.546	8.221
135.560	135.560	
135.561	135.561	10.288
135.551	135.551	
135.560	135.560	11.356
135.304	135.304	11.252
135.497	135.497	12.465
135.453	135.453	12.568
135.372	135.372	
135.365	135.365	
135.360	135.360	
135.384	135.384	
135.420	135.420	
135.438	135.438	
135.459	135.459	

PUNTO KILOMÉTRICO : 29+460

CUT: 67.111 m2
 FILL: 0.658 m2

COTA DE REFERENCIA : 132.000 m.

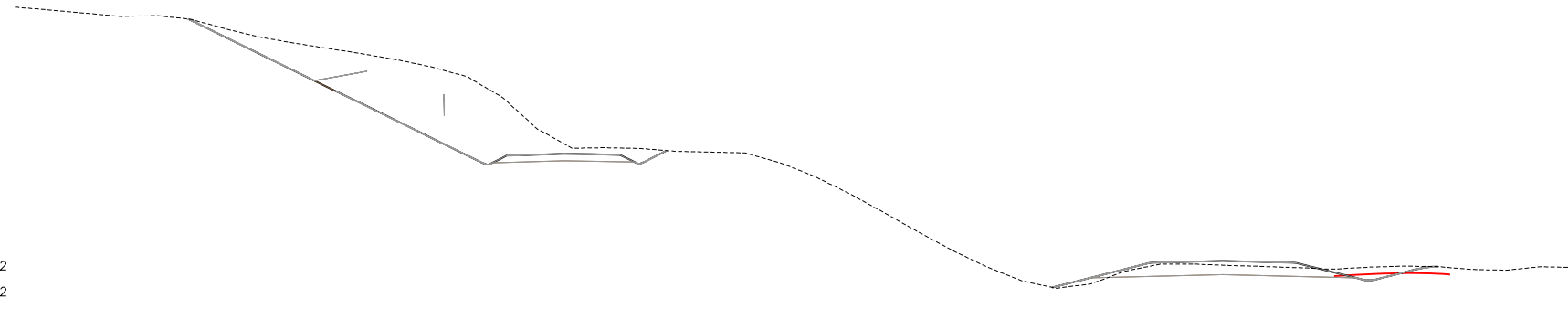

DESIGNED LEVELS	EXISTING LEVELS	OFFSET
151.189	151.189	
151.015	151.015	
150.873	150.873	
150.825	150.825	
150.703	150.703	
150.690	150.690	
150.710	150.710	
150.728	150.728	
150.662	150.662	
150.501	150.501	
150.294	150.294	
149.944	149.944	
149.668	149.668	
149.469	149.469	
149.290	149.290	
149.117	149.117	
148.946	148.946	
148.807	148.807	
148.613	148.613	
148.493	148.493	
148.374	148.374	
148.252	148.252	
148.023	148.023	
147.831	147.831	
147.582	147.582	
147.278	147.278	
146.941	146.941	
145.758	145.758	
144.096	144.096	
143.051	143.051	
143.073	143.073	
143.011	143.011	
142.895	142.895	
142.861	142.861	
142.813	142.813	
142.792	142.792	
142.698	142.698	
142.409	142.409	
142.218	142.218	
141.743	141.743	
141.433	141.433	
140.889	140.889	
140.440	140.440	
139.886	139.886	
139.348	139.348	
138.701	138.701	
138.216	138.216	
137.531	137.531	
137.137	137.137	
136.825	136.825	
136.177	136.177	
135.964	135.964	
135.565	135.565	
135.285	135.285	
135.018	135.018	
134.983	134.983	-9.902
135.268	135.268	-7.076
135.955	135.955	
136.230	136.230	-4.000
136.433	136.433	-3.250
136.241	136.241	
136.452	136.452	
136.338	136.338	0.000
136.533	136.533	
136.253	136.253	
136.219	136.219	
136.187	136.187	
136.152	136.152	3.250
136.433	136.433	4.000
136.119	136.119	
136.054	136.054	
136.034	136.034	
136.087	136.087	6.721
136.122	136.122	8.221
136.168	136.168	8.221
136.188	136.188	
136.198	136.198	10.237
136.226	136.226	11.252
136.048	136.048	11.252
136.205	136.205	12.465
136.123	136.123	
136.036	136.036	
136.011	136.011	
135.987	135.987	
136.064	136.064	
136.116	136.116	
136.159	136.159	
136.199	136.199	
136.157	136.157	

PUNTO KILOMÉTRICO : 29+440

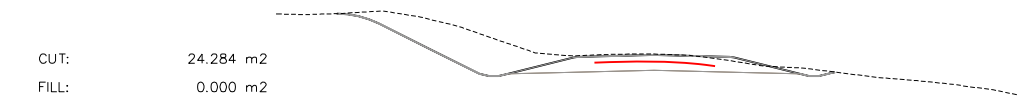

COTA DE REFERENCIA : 126.000 m.

DESIGNED LEVELS	EXISTING LEVELS	OFFSET
132.590	132.590	0.000
132.580	132.580	0.000
132.616	132.616	0.000
132.632	132.632	0.000
132.646	132.646	0.000
132.688	132.688	0.000
132.719	132.719	0.000
132.771	132.771	0.000
132.782	132.782	0.000
132.669	132.669	0.000
132.541	132.541	0.000
130.775	130.775	0.000
131.894	131.894	0.000
131.497	131.497	0.000
129.445	129.445	0.000
130.300	130.300	0.000
131.203	131.203	0.000
128.443	128.443	0.000
130.677	130.677	0.000
130.521	130.521	0.000
130.426	130.426	0.000
130.338	130.338	0.000
130.444	130.444	0.000
130.357	130.357	0.000
130.476	130.476	0.000
130.491	130.491	0.000
130.438	130.438	0.000
130.448	130.448	0.000
130.429	130.429	0.000
130.207	130.207	0.000
130.357	130.357	0.000
129.969	129.969	0.000
129.862	129.862	0.000
129.789	129.789	0.000
129.694	129.694	0.000
129.500	129.500	0.000
129.397	129.397	0.000
129.399	129.399	0.000
129.250	129.250	0.000
129.174	129.174	0.000
128.086	128.086	0.000
128.072	128.072	0.000
128.875	128.875	0.000
128.623	128.623	0.000
128.352	128.352	0.000
128.246	128.246	0.000

PUNTO KILOMÉTRICO : 29+600

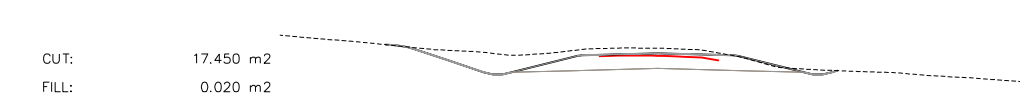

COTA DE REFERENCIA : 124.000 m.

DESIGNED LEVELS	EXISTING LEVELS	OFFSET
129.376	129.376	0.000
129.385	129.385	0.000
129.287	129.287	0.000
129.169	129.169	0.000
129.083	129.083	0.000
128.993	128.993	0.000
128.929	128.929	0.000
128.737	128.737	0.000
128.725	128.725	0.000
128.669	128.669	0.000
128.136	128.136	0.000
128.629	128.629	0.000
128.576	128.576	0.000
127.411	127.411	0.000
128.427	128.427	0.000
127.538	127.538	0.000
128.546	128.546	0.000
128.652	128.652	0.000
128.428	128.428	0.000
128.447	128.447	0.000
128.816	128.816	0.000
128.811	128.811	0.000
128.528	128.528	0.000
128.762	128.762	0.000
128.710	128.710	0.000
128.564	128.564	0.000
128.447	128.447	0.000
128.170	128.170	0.000
128.170	128.170	0.000
127.922	127.922	0.000
127.671	127.671	0.000
127.670	127.670	0.000
127.411	127.411	0.000
127.621	127.621	0.000
127.634	127.634	0.000
127.583	127.583	0.000
127.526	127.526	0.000
127.475	127.475	0.000
127.398	127.398	0.000
127.350	127.350	0.000
127.304	127.304	0.000
127.240	127.240	0.000
127.173	127.173	0.000
127.085	127.085	0.000
127.049	127.049	0.000

PUNTO KILOMÉTRICO : 29+660

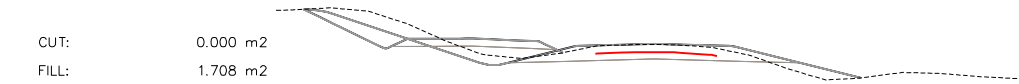

COTA DE REFERENCIA : 127.000 m.

DESIGNED LEVELS	EXISTING LEVELS	OFFSET
132.991	132.991	0.000
132.927	132.927	0.000
132.735	132.735	0.000
132.931	132.931	0.000
132.754	132.754	0.000
132.153	132.153	0.000
131.449	131.449	0.000
131.575	131.575	0.000
131.297	131.297	0.000
130.686	130.686	0.000
130.162	130.162	0.000
130.555	130.555	0.000
130.837	130.837	0.000
130.162	130.162	0.000
130.439	130.439	0.000
130.389	130.389	0.000
130.555	130.555	0.000
130.653	130.653	0.000
130.862	130.862	0.000
131.054	131.054	0.000
131.074	131.074	0.000
131.096	131.096	0.000
131.123	131.123	0.000
131.116	131.116	0.000
131.091	131.091	0.000
130.987	130.987	0.000
131.074	131.074	0.000
130.737	130.737	0.000
130.576	130.576	0.000
129.954	129.954	0.000
129.714	129.714	0.000
130.194	130.194	0.000
129.406	129.406	0.000
129.629	129.629	0.000
129.597	129.597	0.000
129.554	129.554	0.000
129.459	129.459	0.000
129.410	129.410	0.000
129.328	129.328	0.000

PUNTO KILOMÉTRICO : 29+580



COTA DE REFERENCIA : 125.000 m.

DESIGNED LEVELS	EXISTING LEVELS	OFFSET
130.240	130.240	0.000
130.243	130.243	0.000
130.269	130.269	0.000
129.867	129.867	0.000
130.383	130.383	0.000
130.467	130.467	0.000
129.059	129.059	0.000
130.675	130.675	0.000
130.677	130.677	0.000
130.638	130.638	0.000
128.007	128.007	0.000
130.492	130.492	0.000
128.007	128.007	0.000
128.762	128.762	0.000
128.588	128.588	0.000
129.165	129.165	0.000
129.025	129.025	0.000
129.043	129.043	0.000
129.170	129.170	0.000
129.172	129.172	0.000
129.244	129.244	0.000
129.226	129.226	0.000
129.208	129.208	0.000
129.110	129.110	0.000
129.043	129.043	0.000
128.977	128.977	0.000
128.831	128.831	0.000
128.818	128.818	0.000
128.872	128.872	0.000
128.132	128.132	0.000
128.007	128.007	0.000
128.132	128.132	0.000
128.743	128.743	0.000
128.353	128.353	0.000
128.602	128.602	0.000
128.397	128.397	0.000
128.311	128.311	0.000
128.230	128.230	0.000
128.152	128.152	0.000
128.067	128.067	0.000
127.998	127.998	0.000
127.907	127.907	0.000
127.878	127.878	0.000
127.854	127.854	0.000
127.804	127.804	0.000

PUNTO KILOMÉTRICO : 29+640

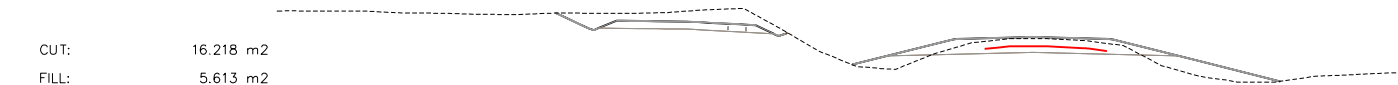

COTA DE REFERENCIA : 127.000 m.

DESIGNED LEVELS	EXISTING LEVELS	OFFSET
133.295	133.295	0.000
133.302	133.302	0.000
133.285	133.285	0.000
133.284	133.284	0.000
133.284	133.284	0.000
133.191	133.191	0.000
133.185	133.185	0.000
133.125	133.125	0.000
133.136	133.136	0.000
133.120	133.120	0.000
133.112	133.112	0.000
133.107	133.107	0.000
133.146	133.146	0.000
133.185	133.185	0.000
133.162	133.162	0.000
133.172	133.172	0.000
133.173	133.173	0.000
133.179	133.179	0.000
133.202	133.202	0.000
133.213	133.213	0.000
133.362	133.362	0.000
133.410	133.410	0.000
133.389	133.389	0.000
133.154	133.154	0.000
131.154	131.154	0.000
130.586	130.586	0.000
130.350	130.350	0.000
130.249	130.249	0.000
130.211	130.211	0.000
130.627	130.627	0.000
131.018	131.018	0.000
131.370	131.370	0.000
131.611	131.611	0.000
131.764	131.764	0.000
131.831	131.831	0.000
131.830	131.830	0.000
131.732	131.732	0.000
131.831	131.831	0.000
131.565	131.565	0.000
131.475	131.475	0.000
130.539	130.539	0.000
130.331	130.331	0.000
129.955	129.955	0.000
130.681	130.681	0.000
129.747	129.747	0.000
129.645	129.645	0.000
129.532	129.532	0.000
129.532	129.532	0.000
129.538	129.538	0.000
129.574	129.574	0.000
129.677	129.677	0.000
129.832	129.832	0.000
129.879	129.879	0.000
129.925	129.925	0.000
129.955	129.955	0.000
129.955	129.955	0.000
129.918	129.918	0.000

PUNTO KILOMÉTRICO : 29+560



COTA DE REFERENCIA : 126.000 m.

DESIGNED LEVELS	EXISTING LEVELS	OFFSET
132.204	132.204	0.000
132.187	132.187	0.000
132.197	132.197	0.000
132.219	132.219	0.000
132.073	132.073	0.000
132.254	132.254	0.000
131.875	131.875	0.000
132.262	132.262	0.000
132.271	132.271	0.000
132.265	132.265	0.000
132.262	132.262	0.000
130.224	130.224	0.000
132.151	132.151	0.000
131.904	131.904	0.000
129.643	129.643	0.000
129.648	129.648	0.000
131.067	131.067	0.000
130.246	130.246	0.000
130.065	130.065	0.000
129.858	129.858	0.000
129.661	129.661	0.000
129.680	129.680	0.000
129.727	129.727	0.000
129.855	129.855	0.000
129.761	129.761	0.000
129.843	129.843	0.000
129.803	129.803	0.000
129.760	129.760	0.000
129.723	129.723	0.000
129.680	129.680	0.000
129.622	129.622	0.000
129.622	129.622	0.000
129.701	129.701	0.000
129.764	129.764	0.000
129.742	129.742	0.000
129.742	129.742	0.000
129.697	129.697	0.000
129.649	129.649	0.000
129.013	129.013	0.000
129.607	129.607	0.000
129.258	129.258	0.000
129.370	129.370	0.000
129.459	129.459	0.000

CUT: 12.850 m2
 FILL: 0.358 m2

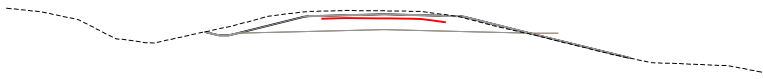

COTA DE REFERENCIA : 122.000 m.

DESIGNED LEVELS	EXISTING LEVELS	OFFSET
	127.754	
	127.535	
	127.548	
	127.079	
	126.270	
	126.139	
	126.939	
	126.223	
	126.390	
	126.613	
	126.352	
	126.352	
	126.824	
	127.029	
	127.183	
	127.431	
	127.559	
	127.612	
	127.659	
	127.457	
	127.618	
	127.516	
	127.438	
	127.329	
	127.089	
	126.796	
	126.958	
	126.958	
	126.341	
	126.207	
	126.234	
	125.920	
	125.767	
	125.337	
	125.135	
	124.854	
	124.801	
	124.750	
	124.561	

PUNTO KILOMÉTRICO : 29+700

CUT: 15.230 m2
 FILL: 0.010 m2



COTA DE REFERENCIA : 123.000 m.

DESIGNED LEVELS	EXISTING LEVELS	OFFSET
	128.389	
	128.271	
	128.210	
	128.158	
	128.149	
	128.103	
	128.053	
	127.999	
	127.738	
	127.558	
	127.489	
	127.484	
	126.892	
	126.892	
	127.426	
	127.542	
	127.680	
	126.980	
	127.861	
	128.123	
	127.872	
	127.891	
	127.972	
	128.208	
	128.208	
	128.189	
	128.130	
	128.044	
	127.891	
	127.662	
	127.488	
	127.488	
	127.158	
	126.882	
	126.882	
	126.908	
	126.682	
	126.620	
	126.459	
	126.408	
	126.330	
	126.304	
	126.241	
	126.136	
	126.021	
	125.892	

PUNTO KILOMÉTRICO : 29+680



ALTERNATIV 6

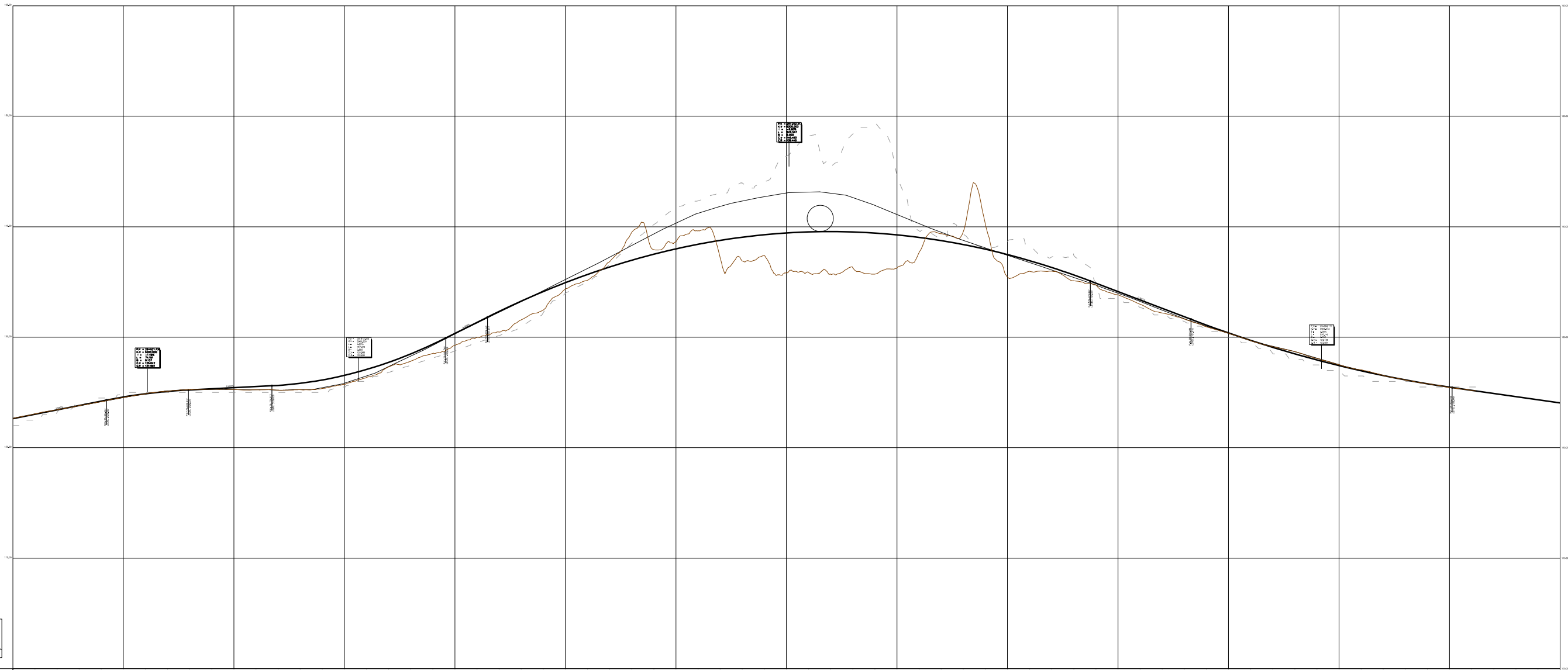

DESIGNED LEVEL	[Grid lines for designed level]																																																																																																			
EXISTING LEVEL	[Grid lines for existing level]																																																																																																			
CHANGE	[Grid lines for change]																																																																																																			
CURVES	[Grid lines for curves]																																																																																																			
GRADES	[Grid lines for grades]																																																																																																			

PROFILE ALTERNATIV 6
 Escala H : 500
 Escala V : 50

CUT: 11.981 m2
 FILL: 0.000 m2

REFERENCE LEVEL: 122.000 m.

DESIGNED LEVELS	EXISTING LEVELS	OFFSET
125.012	124.994	0.018
125.051	125.051	0.000
125.080	125.080	0.000
125.101	125.101	0.000
125.117	125.117	0.000
125.163	125.163	0.000
125.175	125.175	0.000
125.132	125.132	0.000
125.182	125.182	0.000
125.020	125.020	0.000
124.780	124.780	0.000
125.217	125.217	0.000
124.540	124.540	0.000
125.190	125.190	0.000
124.415	124.415	0.000
125.102	125.102	0.000
125.013	125.013	0.000
124.992	124.992	0.000
125.039	125.039	0.000
125.433	125.433	0.000
125.085	125.085	0.000
125.452	125.452	0.000
125.221	125.221	0.000
125.235	125.235	0.000
125.248	125.248	0.000
125.533	125.533	0.000
125.220	125.220	0.000
125.196	125.196	0.000
125.152	125.152	0.000
125.097	125.097	0.000
125.452	125.452	0.000
125.069	125.069	0.000
125.453	125.453	0.000
125.154	125.154	0.000
125.308	125.308	0.000
125.291	125.291	0.000
125.268	125.268	0.000
125.410	125.410	0.000
125.217	125.217	0.000
124.772	124.772	0.000
125.170	125.170	0.000
125.004	125.004	0.000
125.116	125.116	0.000
125.142	125.142	0.000
125.131	125.131	0.000
125.127	125.127	0.000
125.123	125.123	0.000
125.130	125.130	0.000
125.139	125.139	0.000
125.120	125.120	0.000

CHAINAGE: 28+720

CUT: 0.258 m2
 FILL: 13.303 m2

REFERENCE LEVEL: 119.000 m.

DESIGNED LEVELS	EXISTING LEVELS	OFFSET
122.273	122.273	0.000
122.214	122.214	0.000
122.185	122.185	0.000
122.122	122.122	0.000
122.036	122.036	0.000
122.002	122.002	0.000
121.962	121.962	0.000
121.985	121.985	0.000
122.018	122.018	0.000
122.098	122.098	0.000
121.993	121.993	0.000
122.018	122.018	0.000
122.019	122.019	0.000
122.034	122.034	0.000
122.044	122.044	0.000
122.049	122.049	0.000
122.059	122.059	0.000
122.069	122.069	0.000
124.247	124.247	0.000
133.043	133.043	0.000
133.262	133.262	0.000
133.741	133.741	0.000
124.300	124.300	0.000
125.981	125.981	0.000
126.050	126.050	0.000
125.059	125.059	0.000
125.176	125.176	0.000
125.321	125.321	0.000
126.131	126.131	0.000
125.375	125.375	0.000
125.371	125.371	0.000
125.340	125.340	0.000
126.050	126.050	0.000
125.244	125.244	0.000
125.981	125.981	0.000
124.889	124.889	0.000
124.640	124.640	0.000
124.350	124.350	0.000
124.321	124.321	0.000
123.735	123.735	0.000
123.059	123.059	0.000
122.741	122.741	0.000
122.464	122.464	0.000
122.661	122.661	0.000
122.010	122.010	0.000
121.954	121.954	0.000
122.967	122.967	0.000
122.051	122.051	0.000
122.182	122.182	0.000
122.182	122.182	0.000
122.202	122.202	0.000
122.224	122.224	0.000

CHAINAGE: 28+780

CUT: 14.256 m2
 FILL: 0.000 m2

REFERENCE LEVEL: 122.000 m.

DESIGNED LEVELS	EXISTING LEVELS	OFFSET
124.987	124.987	0.000
125.008	125.008	0.000
125.036	125.036	0.000
125.069	125.069	0.000
125.121	125.121	0.000
125.156	125.156	0.000
125.118	125.118	0.000
125.066	125.066	0.000
124.723	124.723	0.000
125.070	125.070	0.000
125.156	125.156	0.000
125.118	125.118	0.000
125.066	125.066	0.000
124.631	124.631	0.000
124.440	124.440	0.000
124.315	124.315	0.000
124.340	124.340	0.000
125.133	125.133	0.000
125.018	125.018	0.000
124.973	124.973	0.000
125.057	125.057	0.000
125.352	125.352	0.000
125.183	125.183	0.000
125.237	125.237	0.000
125.433	125.433	0.000
125.231	125.231	0.000
125.121	125.121	0.000
125.352	125.352	0.000
125.045	125.045	0.000
125.069	125.069	0.000
125.230	125.230	0.000
125.142	125.142	0.000
125.273	125.273	0.000
124.410	124.410	0.000
124.315	124.315	0.000
124.340	124.340	0.000
125.261	125.261	0.000
124.704	124.704	0.000
125.212	125.212	0.000
124.704	124.704	0.000
125.158	125.158	0.000
124.897	124.897	0.000
125.117	125.117	0.000
125.094	125.094	0.000
125.025	125.025	0.000
124.984	124.984	0.000
124.982	124.982	0.000
124.970	124.970	0.000
124.942	124.942	0.000
124.908	124.908	0.000
124.856	124.856	0.000

CHAINAGE: 28+700

CUT: 1.403 m2
 FILL: 7.448 m2

REFERENCE LEVEL: 119.000 m.

DESIGNED LEVELS	EXISTING LEVELS	OFFSET
121.874	121.874	0.000
121.827	121.827	0.000
121.856	121.856	0.000
121.890	121.890	0.000
121.936	121.936	0.000
122.002	122.002	0.000
122.148	122.148	0.000
122.265	122.265	0.000
122.368	122.368	0.000
122.464	122.464	0.000
122.559	122.559	0.000
122.666	122.666	0.000
122.895	122.895	0.000
123.310	123.310	0.000
123.655	123.655	0.000
123.934	123.934	0.000
124.230	124.230	0.000
125.678	125.678	0.000
125.746	125.746	0.000
124.967	124.967	0.000
125.678	125.678	0.000
125.232	125.232	0.000
125.828	125.828	0.000
125.240	125.240	0.000
125.203	125.203	0.000
125.746	125.746	0.000
124.850	124.850	0.000
125.678	125.678	0.000
124.348	124.348	0.000
124.810	124.810	0.000
124.329	124.329	0.000
123.320	123.320	0.000
123.156	123.156	0.000
122.916	122.916	0.000
122.677	122.677	0.000
122.481	122.481	0.000
122.405	122.405	0.000
122.313	122.313	0.000
122.243	122.243	0.000
122.243	122.243	0.000
122.223	122.223	0.000
122.216	122.216	0.000
122.178	122.178	0.000

CHAINAGE: 28+760

CUT: 14.247 m2
 FILL: 0.000 m2

REFERENCE LEVEL: 122.000 m.

DESIGNED LEVELS	EXISTING LEVELS	OFFSET
124.842	124.842	0.000
124.892	124.892	0.000
124.920	124.920	0.000
124.932	124.932	0.000
124.967	124.967	0.000
125.039	125.039	0.000
125.070	125.070	0.000
125.033	125.033	0.000
124.631	124.631	0.000
124.750	124.750	0.000
124.340	124.340	0.000
124.315	124.315	0.000
124.444	124.444	0.000
124.353	124.353	0.000
124.918	124.918	0.000
125.097	125.097	0.000
125.173	125.173	0.000
125.252	125.252	0.000
125.249	125.249	0.000
125.283	125.283	0.000
125.295	125.295	0.000
125.309	125.309	0.000
125.333	125.333	0.000
125.329	125.329	0.000
125.263	125.263	0.000
125.252	125.252	0.000
125.040	125.040	0.000
124.860	124.860	0.000
124.806	124.806	0.000
125.029	125.029	0.000
125.181	125.181	0.000
124.370	124.370	0.000
124.340	124.340	0.000
125.185	125.185	0.000
124.643	124.643	0.000
125.150	125.150	0.000
124.945	124.945	0.000
125.096	125.096	0.000
125.097	125.097	0.000
125.056	125.056	0.000
125.008	125.008	0.000
124.948	124.948	0.000
124.907	124.907	0.000
124.878	124.878	0.000
124.814	124.814	0.000
124.745	124.745	0.000

CHAINAGE: 28+680

CUT: 3.851 m2
 FILL: 0.220 m2

REFERENCE LEVEL: 121.000 m.

DESIGNED LEVELS	EXISTING LEVELS	OFFSET
124.940	124.940	0.000
124.927	124.927	0.000
124.866	124.866	0.000
124.845	124.845	0.000
124.780	124.780	0.000
124.791	124.791	0.000
124.784	124.784	0.000
124.767	124.767	0.000
124.742	124.742	0.000
124.743	124.743	0.000
124.740	124.740	0.000
124.800	124.800	0.000
124.821	124.821	0.000
124.818	124.818	0.000
124.856	124.856	0.000
124.880	124.880	0.000
124.967	124.967	0.000
125.240	125.240	0.000
125.108	125.108	0.000
125.154	125.154	0.000
125.557	125.557	0.000
125.175	125.175	0.000
125.212	125.212	0.000
125.220	125.220	0.000
125.212	125.212	0.000
125.146	125.146	0.000
125.557	125.557	0.000
124.940	124.940	0.000
124.676	124.676	0.000
124.604	124.604	0.000
125.037	125.037	0.000
124.567	124.567	0.000
124.538	124.538	0.000
124.467	124.467	0.000
124.434	124.434	0.000
124.363	124.363	0.000
124.216	124.216	0.000
124.274	124.274	0.000
124.117	124.117	0.000

CUT: 47.525 m2
 FILL: 113.986 m2

REFERENCE LEVEL: 133.000 m.

DESIGNED LEVELS	EXISTING LEVELS	OFFSET
148.055	148.050	
148.124	148.124	
148.148	148.148	
148.271	148.271	
148.398	148.510	-43.055
148.553	148.706	-43.055
149.395	149.395	
150.105	150.402	-37.728
150.714	149.085	-37.728
150.901	150.901	
150.963	150.963	
149.207	151.014	-35.584
151.014	151.014	
151.014	151.014	
149.144	151.015	-33.436
151.015	151.015	
148.897	150.902	-31.302
150.902	150.902	
148.468	150.278	-29.197
149.358	149.358	
147.859	148.337	-27.137
147.341	147.341	
147.076	146.565	-25.136
146.124	143.888	-23.210
145.010	141.079	-21.373
145.010	139.990	-21.373
138.113	138.113	
136.728	136.728	
136.028	136.028	
135.881	135.881	
140.864	135.792	-15.153
140.519	135.723	-14.611
139.900	135.669	-14.484
139.672	135.669	-14.484
139.672	135.566	-12.908
139.158	135.566	-11.704
138.962	135.536	-10.991
138.472	135.503	-10.477
138.472	135.490	-9.971
138.472	135.477	-9.971
138.542	135.503	-9.971
135.544	135.544	
135.509	135.509	
139.410	135.530	-4.500
139.466	135.466	-3.250
139.479	135.558	-3.250
139.578	135.578	
139.574	135.574	0.000
139.560	135.574	0.000
139.479	136.977	3.250
139.479	137.309	4.250
139.435	137.998	39.435
138.662	138.662	
139.640	140.248	141.035
140.248	140.248	141.035
138.554	141.154	8.221
138.554	141.154	8.221
142.224	142.224	
139.818	142.575	11.722
141.068	142.722	14.223
141.968	142.819	14.223
142.958	142.958	
141.968	142.958	16.371
142.645	143.025	18.572
143.025	143.025	14.025
143.025	143.025	14.025
143.045	143.112	20.854
143.180	143.141	14.314
143.180	143.157	14.314
143.260	143.221	23.157
143.400	143.260	14.340
143.675	143.675	14.340
144.461	144.461	26.225
144.461	144.461	26.225
145.045	145.045	

CHAINAGE: 29+240

CUT: 36.223 m2
 FILL: 146.569 m2

REFERENCE LEVEL: 133.000 m.

DESIGNED LEVELS	EXISTING LEVELS	OFFSET
149.150	149.150	
149.195	149.195	
149.292	149.292	
149.336	149.336	
149.432	149.432	
149.517	149.517	
149.674	149.674	
149.866	149.866	
150.029	150.029	
150.141	150.141	
150.514	150.445	-39.873
150.445	150.445	-39.873
151.283	151.283	
151.622	151.622	
151.670	151.670	
151.740	151.740	
151.762	151.762	
151.781	151.781	
150.297	151.610	-33.447
151.610	151.610	
149.868	151.410	-31.342
149.868	151.066	-31.342
149.259	149.651	-29.282
149.259	149.259	
148.476	146.985	-27.281
148.476	146.985	-27.281
147.524	143.848	-24.262
147.524	142.262	-25.355
146.410	139.818	-23.518
146.410	139.818	-23.518
137.351	137.351	
136.408	136.408	
135.840	135.840	
135.707	135.707	
135.516	135.516	
135.566	135.566	
135.584	135.584	
140.834	135.564	-15.153
140.489	135.525	-14.611
139.870	135.484	-14.484
139.672	135.484	-14.484
139.672	135.316	-12.908
139.128	135.290	-11.704
138.932	135.290	-11.704
138.472	135.201	-10.991
138.472	135.188	-10.477
138.472	135.175	-9.971
138.472	135.162	-9.971
138.542	135.162	-9.971
135.485	135.485	
135.485	135.485	
139.380	135.484	-4.500
139.449	135.481	-3.250
139.449	135.480	-3.250
139.510	135.510	
139.510	135.510	
139.449	137.139	3.250
139.449	137.139	3.250
138.100	138.100	
138.518	138.518	
139.160	139.160	
140.146	140.146	
138.537	140.626	7.271
138.537	140.626	7.271
138.537	141.286	8.221
138.537	141.286	8.221
141.925	141.925	
139.889	142.402	11.925
139.889	142.548	14.629
141.241	142.917	14.629
141.241	141.241	
142.141	143.035	16.716
143.035	143.035	14.035
143.140	143.140	14.035
142.818	143.169	18.978
142.818	143.170	14.035
143.218	143.156	21.260
143.218	143.156	21.260
143.353	143.102	23.573
143.353	143.102	23.573
144.093	144.093	
144.461	144.461	
144.461	144.461	
144.530	144.530	
144.588	144.588	
144.588	144.588	

CHAINAGE: 29+220

CUT: 38.133 m2
 FILL: 138.465 m2

REFERENCE LEVEL: 133.000 m.

DESIGNED LEVELS	EXISTING LEVELS	OFFSET
148.758	148.758	
148.815	148.815	
148.942	148.942	
149.058	149.058	
149.211	149.211	
149.311	149.311	
149.403	149.403	
149.540	149.540	
149.686	149.686	
149.859	149.859	
150.025	150.025	
150.447	150.447	
150.390	150.390	
150.623	150.623	
150.701	150.701	
150.859	150.859	
150.496	151.056	-35.578
151.056	151.056	
150.259	151.072	-34.532
151.072	151.072	
149.830	150.800	-31.427
149.830	150.800	-31.427
149.221	150.244	-29.367
149.221	149.344	-27.367
148.438	148.196	-25.441
148.438	145.495	-23.604
147.486	143.207	-21.301
147.486	143.207	-21.301
146.373	139.801	-16.373
146.373	139.801	-16.373
136.617	136.617	
135.831	135.831	
135.644	135.644	
135.584	135.584	
135.532	135.532	
140.739	135.500	-15.153
140.394	135.482	-14.611
139.775	135.480	-14.484
139.502	135.480	-14.484
139.502	135.316	-12.908
139.033	135.290	-11.704
138.837	135.290	-11.704
138.668	135.188	-10.991
138.668	135.175	-10.477
138.668	135.162	-9.971
138.668	135.162	-9.971
138.748	135.162	-9.971
135.696	135.696	
135.500	135.500	
135.502	135.502	
139.286	135.500	-4.500
139.354	135.500	-3.250
139.354	135.516	
139.436	135.673	0.000
139.436	136.089	3.250
139.354	137.784	13.250
139.354	139.354	
139.163	139.163	
140.340	140.340	
140.779	140.779	
138.443	141.624	7.271
138.443	141.624	7.271
138.443	142.109	8.221
138.443	142.109	8.221
139.708	142.287	11.752
139.708	142.793	14.287
140.974	143.019	14.287
140.974	143.040	14.287
141.873	143.056	16.371
141.873	143.089	14.035
141.873	143.113	14.035
142.550	143.093	18.632
142.550	143.026	14.026
142.951	143.026	20.914
143.085	143.015	23.228
143.085	143.085	
143.170	143.154	14.314
143.170	143.170	14.314
143.225	143.225	
143.258	143.258	
143.273	143.273	
143.294	143.294	

CHAINAGE: 29+200

CUT: 31.245 m2
FILL: 4.027 m2

REFERENCE LEVEL: 133.000 m.

DESIGNED LEVELS	EXISTING LEVELS	OFFSET
143.505	143.505	
143.513	143.513	
143.523	143.523	
143.534	143.534	
143.401	143.399	-0.002
143.308	143.286	-0.022
143.118	143.091	-0.027
143.522	143.450	-0.072
143.400	143.400	
143.337	143.337	
143.144	142.793	-0.351
142.793	142.463	-0.330
141.531	139.403	-2.128
140.740	140.261	-0.479
139.230	139.230	
138.662	138.662	
137.891	137.891	
137.134	137.134	
136.731	136.731	
136.248	136.248	
135.860	135.860	
135.583	135.583	
135.369	135.369	
135.302	135.302	
135.260	135.260	
135.383	135.383	
135.749	135.749	
135.973	135.973	
136.927	136.927	
136.452	136.452	
136.534	136.534	
136.646	136.646	
136.846	136.846	
136.664	136.664	
136.664	136.664	
136.657	136.657	
136.657	136.657	
136.724	136.724	
136.769	136.769	
136.935	136.935	
136.843	136.843	
136.167	136.167	
11.080	136.697	135.617
136.540	136.540	
136.518	136.518	
12.293	136.552	135.359
136.580	136.580	
136.609	136.609	
136.679	136.679	
136.753	136.753	
136.753	136.753	
136.753	136.753	

CHAINAGE: 29+420

CUT: 14.832 m2
FILL: 0.000 m2

REFERENCE LEVEL: 131.000 m.

DESIGNED LEVELS	EXISTING LEVELS	OFFSET
135.885	135.885	
135.585	135.585	
135.379	135.379	
135.029	135.029	
134.992	134.992	
134.863	134.863	
134.863	134.863	
134.840	134.840	
134.811	134.811	
134.811	134.811	
134.786	134.786	
134.751	134.751	
134.298	134.298	
134.695	134.695	
134.666	134.666	
134.666	134.666	
134.622	134.622	
134.616	134.616	
134.628	134.628	
134.698	134.698	
134.809	134.809	
134.880	134.880	
134.668	134.668	
134.583	134.583	
134.495	134.495	
134.790	134.790	
134.467	134.467	
134.494	134.494	
134.898	134.898	
134.774	134.774	
134.612	134.612	
134.612	134.612	
134.714	134.714	
134.737	134.737	
134.600	134.600	
134.751	134.751	
134.712	134.712	
134.726	134.726	
134.630	134.630	
134.553	134.553	
134.431	134.431	
134.387	134.387	
134.348	134.348	
134.345	134.345	
134.359	134.359	

CHAINAGE: 29+480

CUT: 28.885 m2
FILL: 8.168 m2

REFERENCE LEVEL: 133.000 m.

DESIGNED LEVELS	EXISTING LEVELS	OFFSET
143.929	143.929	
143.868	143.868	
143.829	143.829	
143.854	143.854	
143.811	143.811	
143.776	143.776	
143.776	143.776	
143.776	143.776	
143.898	143.898	
143.885	143.885	
143.839	143.839	
143.799	143.799	
143.355	142.995	-0.360
142.995	142.995	
142.298	141.833	-0.465
141.833	139.884	-1.949
141.469	140.882	-0.587
140.882	140.377	-0.505
139.277	138.668	-0.609
138.668	138.668	
138.051	138.051	
137.985	137.985	
137.098	137.098	
136.883	136.883	
136.794	136.794	
136.641	136.641	
136.641	136.641	
137.148	137.148	
136.008	136.008	
135.781	135.781	
137.397	137.397	
135.546	135.546	
135.389	135.389	
135.403	135.403	
137.478	137.478	
136.132	136.132	
136.452	136.452	
137.397	137.397	
136.809	136.809	
136.937	136.937	
136.937	136.937	
136.981	136.981	
136.985	136.985	
137.009	137.009	
136.860	136.860	
136.860	136.860	
137.151	137.151	
136.883	136.883	
136.847	136.847	
137.336	137.336	
136.847	136.847	
137.358	137.358	
137.453	137.453	
137.209	137.209	
137.321	137.321	
137.359	137.359	
137.306	137.306	
137.266	137.266	
137.284	137.284	
137.320	137.320	
137.370	137.370	

CHAINAGE: 29+400

CUT: 14.396 m2
FILL: 0.179 m2

REFERENCE LEVEL: 132.000 m.

DESIGNED LEVELS	EXISTING LEVELS	OFFSET
141.395	141.395	
141.249	141.249	
141.260	141.260	
141.160	141.160	
140.765	140.765	
140.765	140.765	
140.430	140.430	
140.220	140.220	
139.654	139.654	
139.326	139.326	
138.826	138.826	
138.449	138.449	
137.965	137.965	
137.703	137.703	
137.506	137.506	
136.648	136.648	
136.190	136.190	
135.911	135.911	
135.499	135.499	
135.277	135.277	
135.170	135.170	
135.052	135.052	
135.026	135.026	
135.100	135.100	
135.211	135.211	
135.259	135.259	
134.947	134.947	
134.950	134.950	
135.551	135.551	
135.018	135.018	
135.633	135.633	
135.150	135.150	
135.167	135.167	
135.143	135.143	
135.147	135.147	
135.161	135.161	
134.640	134.640	
134.572	134.572	
134.640	134.640	
135.254	135.254	
134.944	134.944	
135.312	135.312	
135.266	135.266	
135.397	135.397	
135.398	135.398	
12.868	12.868	
135.409	135.409	
135.437	135.437	
135.453	135.453	
135.351	135.351	
135.241	135.241	
135.328	135.328	
135.444	135.444	

CHAINAGE: 29+460

CUT: 121.180 m2
FILL: 0.000 m2

REFERENCE LEVEL: 134.000 m.

DESIGNED LEVELS	EXISTING LEVELS	OFFSET
144.271	144.271	
144.217	144.217	
144.129	144.129	
144.050	144.050	
144.150	144.150	
144.245	144.245	
144.208	144.208	
144.195	144.195	
143.938	143.938	
144.148	144.148	
144.082	144.082	
144.003	144.003	
143.907	143.907	
143.597	143.597	
143.704	140.342	-3.362
143.886	143.886	
144.402	144.402	
145.145	145.145	
145.348	145.348	
145.469	145.469	
145.071	145.071	
144.851	144.851	
144.851	144.851	
144.221	144.221	
143.132	143.132	
142.707	142.707	
142.277	137.883	-4.394
141.796	141.796	
141.165	141.165	
140.600	137.964	-2.636
140.240	140.240	
139.472	139.472	
138.650	138.650	
138.293	138.293	
137.710	137.710	
137.466	137.466	
137.441	137.441	
137.441	137.441	
137.481	137.481	
137.521	137.521	
137.521	137.521	
137.413	137.413	
137.565	137.565	
137.557	137.557	
137.581	137.581	
137.723	137.723	
137.841	137.841	
137.979	137.979	
138.014	138.014	
138.024	138.024	

CHAINAGE: 29+380

CUT: 28.849 m2
FILL: 1.153 m2

REFERENCE LEVEL: 133.000 m.

DESIGNED LEVELS	EXISTING LEVELS	OFFSET
142.689	142.689	
142.669	142.669	
142.623	142.623	
142.560	142.560	
142.526	142.526	
142.526	142.526	
142.530	142.530	
142.494	142.494	
142.274	142.274	
142.493	142.493	
142.000	142.000	
142.079	142.079	
141.264	141.264	
140.571	140.571	
140.179	138.660	-1.519
139.624	139.624	
139.354	139.354	
138.692	138.692	
138.343	138.343	
137.751	137.751	
137.313	137.313	
136.810	136.810	
136.319	136.319	
135.914	135.914	
135.519	135.519	
135.174	135.174	
135.174	135.174	
135.673	135.673	
135.800	135.800	
135.457	135.457	
135.711	135.711	
135.656	135.656	
135.205	135.205	
136.005	136.005	
135.029	135.029	
136.231	136.231	
135.315	135.315	
135.460	135.460	
135.857	135.857	
136.312	136.312	
136.227	136.227	
136.270	136.270	
136.212	136.212	
136.226	136.226	
136.213	136.213	
136.216	136.216	
135.319	135.319	
135.194	135.194	
135.319	135.319	
135.569	135.569	
135.022	135.022	
135.819	135.819	
135.922	135.922	
135.921	135.921	
135.968	135.968	
136.042	136.042	
136.068	136.068	
136.103	136.103	
136.100	136.100	
136.095	136.095	
136.036	136.036	
135.917	135.917	

CHAINAGE: 29+440

CUT: 14.852 m2
 FILL: 0.086 m2

REFERENCE LEVEL: 124.000 m.

DESIGNED LEVELS	EXISTING LEVELS	OFFSET
129.378	129.378	0.000
129.320	129.320	0.000
129.304	129.304	0.000
129.210	129.210	0.000
129.145	129.145	0.000
129.091	129.091	0.000
129.027	129.027	0.000
128.984	128.984	0.000
128.854	128.854	0.000
128.663	128.663	0.000
128.167	128.167	0.000
128.326	128.326	0.000
128.257	128.257	0.000
127.499	127.499	0.000
127.374	127.374	0.000
127.499	127.499	0.000
127.374	127.374	0.000
127.031	127.031	0.000
126.878	126.878	0.000

CHAINAGE: 29+660

CUT: 21.002 m2
 FILL: 0.000 m2

REFERENCE LEVEL: 125.000 m.

DESIGNED LEVELS	EXISTING LEVELS	OFFSET
130.311	130.311	0.000
130.252	130.252	0.000
130.187	130.187	0.000
130.112	130.112	0.000
130.037	130.037	0.000
130.026	130.026	0.000
129.962	129.962	0.000
129.769	129.769	0.000
129.847	129.847	0.000
129.843	129.843	0.000
129.930	129.930	0.000
129.900	129.900	0.000
129.891	129.891	0.000
129.865	129.865	0.000
129.809	129.809	0.000
129.688	129.688	0.000
129.002	129.002	0.000
129.002	129.002	0.000
128.984	128.984	0.000
129.115	129.115	0.000
129.059	129.059	0.000
129.002	129.002	0.000
128.984	128.984	0.000
128.630	128.630	0.000
128.602	128.602	0.000
128.542	128.542	0.000
128.440	128.440	0.000
128.354	128.354	0.000
128.244	128.244	0.000
128.282	128.282	0.000
128.108	128.108	0.000
128.045	128.045	0.000
128.015	128.015	0.000
127.833	127.833	0.000
127.778	127.778	0.000
127.644	127.644	0.000

CHAINAGE: 29+640

CUT: 11.236 m2
 FILL: 0.000 m2

REFERENCE LEVEL: 121.000 m.

DESIGNED LEVELS	EXISTING LEVELS	OFFSET
127.445	127.445	0.000
126.912	126.912	0.000
126.638	126.638	0.000
126.594	126.594	0.000
126.564	126.564	0.000
126.508	126.508	0.000
126.629	126.629	0.000
126.816	126.816	0.000
126.988	126.988	0.000
127.298	127.298	0.000
127.539	127.539	0.000
127.511	127.511	0.000
127.504	127.504	0.000
127.451	127.451	0.000
127.331	127.331	0.000
127.349	127.349	0.000
127.510	127.510	0.000
127.515	127.515	0.000
127.504	127.504	0.000
127.455	127.455	0.000
127.400	127.400	0.000
127.349	127.349	0.000
127.331	127.331	0.000
127.281	127.281	0.000
127.056	127.056	0.000
126.478	126.478	0.000
126.453	126.453	0.000
126.420	126.420	0.000
126.699	126.699	0.000
126.682	126.682	0.000
125.485	125.485	0.000
125.179	125.179	0.000
125.021	125.021	0.000
124.792	124.792	0.000
124.409	124.409	0.000
124.254	124.254	0.000
124.064	124.064	0.000
124.004	124.004	0.000
123.890	123.890	0.000

CHAINAGE: 29+700

CUT: 29.743 m2
 FILL: 0.000 m2

REFERENCE LEVEL: 126.000 m.

DESIGNED LEVELS	EXISTING LEVELS	OFFSET
131.220	131.220	0.000
131.218	131.218	0.000
131.263	131.263	0.000
131.271	131.271	0.000
131.298	131.298	0.000
131.014	131.014	0.000
131.264	131.264	0.000
131.268	131.268	0.000
131.282	131.282	0.000
129.868	129.868	0.000
131.342	131.342	0.000
131.142	131.142	0.000
130.722	130.722	0.000
130.965	130.965	0.000
130.601	130.601	0.000
130.414	130.414	0.000
129.926	129.926	0.000
129.593	129.593	0.000
129.643	129.643	0.000
129.615	129.615	0.000
129.634	129.634	0.000
129.684	129.684	0.000
129.692	129.692	0.000
129.701	129.701	0.000
129.701	129.701	0.000
129.688	129.688	0.000
129.715	129.715	0.000
129.672	129.672	0.000
129.647	129.647	0.000
129.638	129.638	0.000
129.634	129.634	0.000
129.615	129.615	0.000
129.605	129.605	0.000
129.597	129.597	0.000
129.563	129.563	0.000
129.531	129.531	0.000
128.722	128.722	0.000
128.722	128.722	0.000
128.722	128.722	0.000
128.722	128.722	0.000
129.481	129.481	0.000
129.402	129.402	0.000
128.907	128.907	0.000
129.092	129.092	0.000
129.334	129.334	0.000
129.241	129.241	0.000
129.088	129.088	0.000
128.885	128.885	0.000
128.737	128.737	0.000
128.667	128.667	0.000
128.487	128.487	0.000
128.384	128.384	0.000

CHAINAGE: 29+620

CUT: 12.659 m2
 FILL: 0.070 m2

REFERENCE LEVEL: 123.000 m.

DESIGNED LEVELS	EXISTING LEVELS	OFFSET
127.940	127.940	0.000
127.892	127.892	0.000
127.890	127.890	0.000
127.750	127.750	0.000
127.616	127.616	0.000
127.509	127.509	0.000
127.376	127.376	0.000
127.275	127.275	0.000
127.208	127.208	0.000
127.161	127.161	0.000
127.145	127.145	0.000
127.161	127.161	0.000
127.145	127.145	0.000
127.141	127.141	0.000
127.141	127.141	0.000
127.632	127.632	0.000
127.843	127.843	0.000
127.996	127.996	0.000
128.041	128.041	0.000
127.841	127.841	0.000
128.065	128.065	0.000
127.860	127.860	0.000
128.079	128.079	0.000
128.076	128.076	0.000
128.076	128.076	0.000
128.059	128.059	0.000
128.059	128.059	0.000
127.976	127.976	0.000
127.976	127.976	0.000
127.976	127.976	0.000
127.976	127.976	0.000
127.841	127.841	0.000
127.841	127.841	0.000
127.534	127.534	0.000
127.442	127.442	0.000
127.183	127.183	0.000
127.252	127.252	0.000
126.990	126.990	0.000
126.948	126.948	0.000
126.948	126.948	0.000
126.948	126.948	0.000
126.670	126.670	0.000
126.582	126.582	0.000
126.528	126.528	0.000
126.504	126.504	0.000
126.464	126.464	0.000
126.410	126.410	0.000
126.339	126.339	0.000
126.248	126.248	0.000
126.195	126.195	0.000
126.130	126.130	0.000
126.062	126.062	0.000
125.965	125.965	0.000

CHAINAGE: 29+680

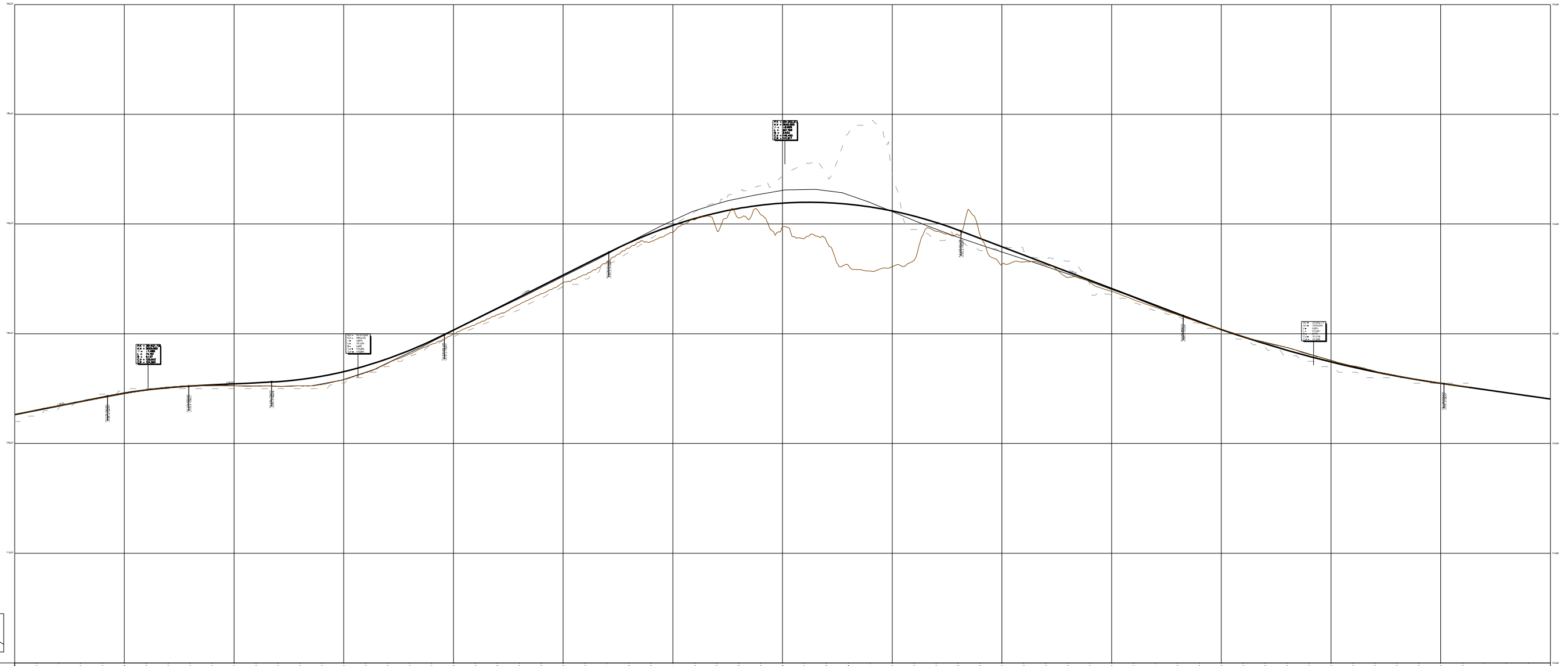

CHANGES	28+500,00	28+600,00	28+700,00	28+800,00	28+900,00	29+000,00	29+100,00	29+200,00	29+300,00	29+400,00	29+500,00	29+600,00	29+700,00	29+800,00	29+900,00
DESIGNATED CURVES															
EXISTING PROFILE															
PROPOSED PROFILE															
CURVATURES															
SUPERELEVATION															

PROFIL ALTERNATIV 7
 Escala H : 500
 Escala V : 50

CUT: 6.191 m2
 FILL: 15.993 m2

COTA DE REFERENCIA : 127.000 m.

DESIGNED LEVELS	EXISTING LEVELS	OFFSET
129.887	129.887	0.000
130.109	130.109	0.000
130.370	130.370	0.000
130.775	130.775	0.000
130.833	130.833	0.000
130.837	130.837	0.000
130.827	130.827	0.000
130.718	130.718	0.000
130.865	130.865	0.000
130.977	130.977	0.000
130.380	130.380	0.000
130.070	130.070	0.000
129.992	129.992	0.000
130.106	130.106	0.000
132.098	132.098	0.000
130.457	130.457	0.000
130.685	130.685	0.000
130.806	130.806	0.000
131.039	131.039	0.000
131.565	131.565	0.000
132.344	132.344	0.000
132.666	132.666	0.000
133.344	133.344	0.000
132.943	132.943	0.000
133.137	133.137	0.000
133.177	133.177	0.000
133.263	133.263	0.000
133.211	133.211	0.000
133.141	133.141	0.000
133.079	133.079	0.000
132.951	132.951	0.000
132.886	132.886	0.000
132.741	132.741	0.000
132.624	132.624	0.000
132.495	132.495	0.000
132.463	132.463	0.000
132.501	132.501	0.000
131.926	131.926	0.000
131.754	131.754	0.000
131.718	131.718	0.000
131.734	131.734	0.000
131.816	131.816	0.000
131.871	131.871	0.000
131.948	131.948	0.000
132.080	132.080	0.000
132.492	132.492	0.000

PUNTO KILOMÉTRICO : 28+960

CUT: 6.194 m2
 FILL: 2.666 m2

COTA DE REFERENCIA : 132.000 m.

DESIGNED LEVELS	EXISTING LEVELS	OFFSET
134.368	134.368	0.000
134.445	134.445	0.000
134.542	134.542	0.000
134.582	134.582	0.000
134.677	134.677	0.000
134.722	134.722	0.000
134.737	134.737	0.000
134.784	134.784	0.000
134.866	134.866	0.000
134.907	134.907	0.000
134.944	134.944	0.000
135.056	135.056	0.000
135.023	135.023	0.000
135.094	135.094	0.000
135.637	135.637	0.000
135.134	135.134	0.000
135.153	135.153	0.000
136.243	136.243	0.000
136.262	136.262	0.000
135.193	135.193	0.000
135.241	135.241	0.000
135.381	135.381	0.000
135.504	135.504	0.000
136.033	136.033	0.000
136.126	136.126	0.000
136.262	136.262	0.000
136.181	136.181	0.000
136.206	136.206	0.000
136.203	136.203	0.000
136.193	136.193	0.000
136.147	136.147	0.000
135.950	135.950	0.000
135.824	135.824	0.000
135.741	135.741	0.000
135.655	135.655	0.000
135.947	135.947	0.000
135.861	135.861	0.000
135.642	135.642	0.000
135.501	135.501	0.000
135.437	135.437	0.000
135.454	135.454	0.000
135.477	135.477	0.000
135.524	135.524	0.000
135.524	135.524	0.000
135.489	135.489	0.000
135.459	135.459	0.000
135.453	135.453	0.000
135.501	135.501	0.000

PUNTO KILOMÉTRICO : 29+020

CUT: 6.898 m2
 FILL: 11.657 m2

COTA DE REFERENCIA : 127.000 m.

DESIGNED LEVELS	EXISTING LEVELS	OFFSET
129.417	129.417	0.000
129.545	129.545	0.000
129.821	129.821	0.000
129.924	129.924	0.000
130.051	130.051	0.000
130.112	130.112	0.000
130.170	130.170	0.000
130.087	130.087	0.000
130.033	130.033	0.000
130.236	130.236	0.000
129.845	129.845	0.000
129.744	129.744	0.000
129.626	129.626	0.000
129.913	129.913	0.000
131.228	131.228	0.000
130.035	130.035	0.000
130.060	130.060	0.000
130.154	130.154	0.000
130.210	130.210	0.000
130.272	130.272	0.000
132.263	132.263	0.000
130.449	130.449	0.000
130.098	130.098	0.000
131.253	131.253	0.000
131.747	131.747	0.000
132.344	132.344	0.000
132.133	132.133	0.000
132.251	132.251	0.000
132.263	132.263	0.000
132.275	132.275	0.000
132.250	132.250	0.000
132.136	132.136	0.000
132.062	132.062	0.000
131.952	131.952	0.000
131.888	131.888	0.000
131.742	131.742	0.000
131.664	131.664	0.000
131.464	131.464	0.000
131.339	131.339	0.000
131.501	131.501	0.000
131.149	131.149	0.000
131.129	131.129	0.000
131.193	131.193	0.000
131.212	131.212	0.000
131.233	131.233	0.000
131.258	131.258	0.000
131.279	131.279	0.000
131.385	131.385	0.000
131.482	131.482	0.000
131.653	131.653	0.000

PUNTO KILOMÉTRICO : 28+940

CUT: 7.049 m2
 FILL: 1.147 m2

COTA DE REFERENCIA : 130.000 m.

DESIGNED LEVELS	EXISTING LEVELS	OFFSET
133.012	133.012	0.000
133.016	133.016	0.000
133.061	133.061	0.000
133.099	133.099	0.000
133.810	133.810	0.000
132.794	132.794	0.000
132.741	132.741	0.000
132.778	132.778	0.000
132.890	132.890	0.000
133.000	133.000	0.000
133.359	133.359	0.000
133.478	133.478	0.000
133.640	133.640	0.000
133.876	133.876	0.000
134.054	134.054	0.000
134.048	134.048	0.000
134.109	134.109	0.000
134.182	134.182	0.000
134.298	134.298	0.000
134.298	134.298	0.000
135.243	135.243	0.000
135.262	135.262	0.000
134.425	134.425	0.000
134.459	134.459	0.000
134.520	134.520	0.000
134.662	134.662	0.000
134.968	134.968	0.000
135.108	135.108	0.000
135.213	135.213	0.000
135.241	135.241	0.000
135.241	135.241	0.000
135.208	135.208	0.000
135.186	135.186	0.000
135.089	135.089	0.000
134.924	134.924	0.000
134.839	134.839	0.000
134.622	134.622	0.000
134.588	134.588	0.000
134.390	134.390	0.000
134.246	134.246	0.000
134.267	134.267	0.000
134.358	134.358	0.000
134.348	134.348	0.000
134.294	134.294	0.000
134.256	134.256	0.000
134.250	134.250	0.000
134.297	134.297	0.000
134.331	134.331	0.000

PUNTO KILOMÉTRICO : 29+000

CUT: 6.946 m2
 FILL: 7.848 m2

COTA DE REFERENCIA : 126.000 m.

DESIGNED LEVELS	EXISTING LEVELS	OFFSET
128.870	128.870	0.000
128.876	128.876	0.000
129.118	129.118	0.000
129.270	129.270	0.000
129.419	129.419	0.000
129.466	129.466	0.000
129.349	129.349	0.000
129.216	129.216	0.000
129.165	129.165	0.000
129.366	129.366	0.000
129.090	129.090	0.000
129.080	129.080	0.000
129.215	129.215	0.000
129.301	129.301	0.000
130.293	130.293	0.000
129.447	129.447	0.000
129.614	129.614	0.000
129.628	129.628	0.000
131.264	131.264	0.000
130.435	130.435	0.000
130.820	130.820	0.000
131.345	131.345	0.000
131.094	131.094	0.000
131.172	131.172	0.000
131.246	131.246	0.000
131.264	131.264	0.000
131.270	131.270	0.000
131.257	131.257	0.000
131.212	131.212	0.000
131.130	131.130	0.000
130.952	130.952	0.000
130.853	130.853	0.000
130.642	130.642	0.000
130.634	130.634	0.000
130.533	130.533	0.000
130.645	130.645	0.000
130.645	130.645	0.000
130.682	130.682	0.000
130.722	130.722	0.000
130.895	130.895	0.000
131.003	131.003	0.000
131.093	131.093	0.000
131.191	131.191	0.000
131.367	131.367	0.000
131.553	131.553	0.000
131.709	131.709	0.000

PUNTO KILOMÉTRICO : 28+920

CUT: 6.680 m2
 FILL: 17.897 m2

COTA DE REFERENCIA : 128.000 m.

DESIGNED LEVELS	EXISTING LEVELS	OFFSET
131.489	131.489	0.000
131.702	131.702	0.000
131.717	131.717	0.000
131.717	131.717	0.000
131.633	131.633	0.000
131.783	131.783	0.000
130.983	130.983	0.000
130.855	130.855	0.000
130.650	130.650	0.000
131.000	131.000	0.000
133.001	133.001	0.000
131.315	131.315	0.000
131.442	131.442	0.000
131.725	131.725	0.000
131.995	131.995	0.000
132.292	132.292	0.000
132.474	132.474	0.000
134.262	134.262	0.000
132.892	132.892	0.000
133.347	133.347	0.000
133.645	133.645	0.000
134.344	134.344	0.000
133.919	133.919	0.000
134.094	134.094	0.000
134.262	134.262	0.000
134.247	134.247	0.000
134.247	134.247	0.000
134.243	134.243	0.000
134.117	134.117	0.000
133.951	133.951	0.000
133.726	133.726	0.000
133.924	133.924	0.000
133.761	133.761	0.000
133.584	133.584	0.000
133.500	133.500	0.000
133.600	133.600	0.000
133.091	133.091	0.000
133.083	133.083	0.000
133.154	133.154	0.000
133.215	133.215	0.000
133.289	133.289	0.000
133.341	133.341	0.000

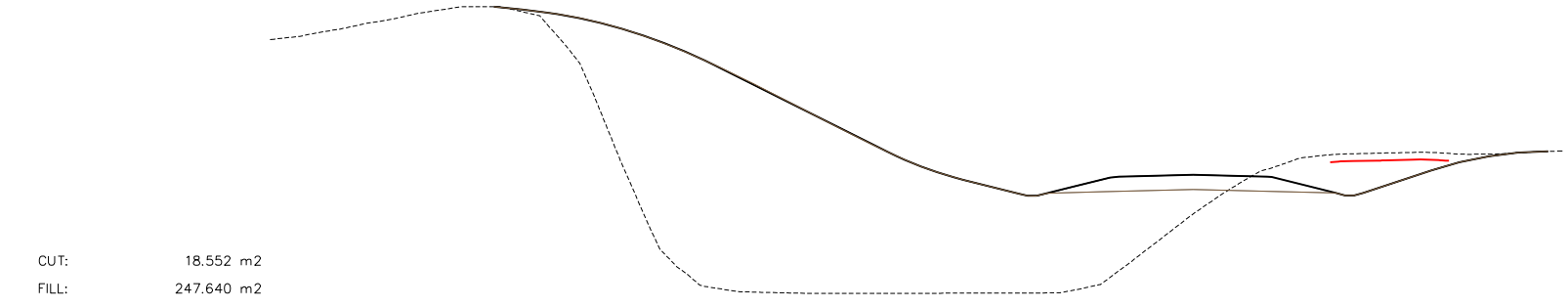

CUT: 18.552 m2
 FILL: 247.640 m2
 COTA DE REFERENCIA : 133.000 m.

DESIGNED LEVELS	EXISTING LEVELS	OFFSET
149.287	149.287	0.000
149.386	149.386	0.000
149.506	149.506	0.000
149.817	149.817	0.000
150.092	150.092	0.000
150.197	150.197	0.000
150.350	150.350	0.000
150.651	150.651	0.000
150.931	150.931	0.000
150.985	150.985	0.000
150.992	150.992	0.000
150.906	150.906	0.000
150.680	150.680	0.000
150.499	150.499	0.000
150.674	150.674	0.000
149.015	149.015	0.000
150.446	150.446	0.000
146.432	146.432	0.000
149.807	149.807	0.000
149.398	149.398	0.000
148.931	148.931	0.000
148.928	148.928	0.000
148.405	148.405	0.000
135.962	135.962	0.000
135.757	135.757	0.000
147.822	147.822	0.000
135.573	135.573	0.000
135.541	135.541	0.000
135.517	135.517	0.000
135.504	135.504	0.000
135.484	135.484	0.000
135.481	135.481	0.000
135.484	135.484	0.000
135.485	135.485	0.000
135.486	135.486	0.000
135.481	135.481	0.000
135.482	135.482	0.000
135.481	135.481	0.000
135.480	135.480	0.000
135.480	135.480	0.000
135.496	135.496	0.000
141.636	141.636	0.000
135.501	135.501	0.000
135.500	135.500	0.000
140.985	140.985	0.000
140.984	140.984	0.000
140.761	140.761	0.000
135.506	135.506	0.000
135.524	135.524	0.000
135.630	135.630	0.000
141.255	141.255	0.000
141.753	141.753	0.000
141.822	141.822	0.000
137.067	137.067	0.000
137.588	137.588	0.000
138.249	138.249	0.000
138.253	138.253	0.000
140.512	140.512	0.000
141.422	141.422	0.000
141.822	141.822	0.000
142.098	142.098	0.000
142.614	142.614	0.000
142.615	142.615	0.000
142.962	142.962	0.000
140.902	140.902	0.000
140.785	140.785	0.000
143.038	143.038	0.000
140.900	140.900	0.000
143.065	143.065	0.000
141.524	141.524	0.000
143.108	143.108	0.000
143.123	143.123	0.000
142.136	142.136	0.000
143.094	143.094	0.000
143.017	143.017	0.000
142.577	142.577	0.000
143.011	143.011	0.000
142.906	142.906	0.000
143.075	143.075	0.000
143.099	143.099	0.000
143.154	143.154	0.000
143.162	143.162	0.000

PUNTO KILOMÉTRICO : 29+200

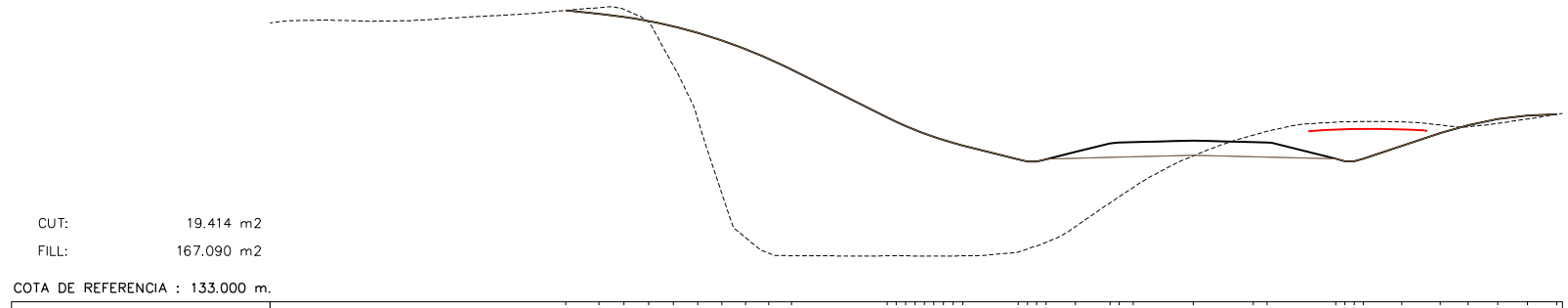

CUT: 19.414 m2
 FILL: 167.090 m2
 COTA DE REFERENCIA : 133.000 m.

DESIGNED LEVELS	EXISTING LEVELS	OFFSET
148.151	148.151	0.000
148.206	148.206	0.000
148.224	148.224	0.000
148.230	148.230	0.000
148.213	148.213	0.000
148.171	148.171	0.000
148.190	148.190	0.000
148.199	148.199	0.000
148.249	148.249	0.000
148.373	148.373	0.000
148.376	148.376	0.000
148.432	148.432	0.000
148.463	148.463	0.000
148.539	148.539	0.000
148.612	148.612	0.000
148.676	148.676	0.000
148.755	148.755	0.000
148.881	148.881	0.000
148.975	148.975	0.000
148.408	148.408	0.000
148.180	148.180	0.000
147.891	147.891	0.000
147.542	147.542	0.000
147.133	147.133	0.000
146.665	146.665	0.000
146.139	146.139	0.000
145.557	145.557	0.000
145.479	145.479	0.000
135.470	135.470	0.000
135.466	135.466	0.000
135.468	135.468	0.000
135.475	135.475	0.000
135.475	135.475	0.000
135.475	135.475	0.000
135.466	135.466	0.000
135.464	135.464	0.000
135.464	135.464	0.000
135.474	135.474	0.000
141.249	141.249	0.000
135.505	135.505	0.000
135.578	135.578	0.000
140.992	140.992	0.000
140.991	140.991	0.000
140.865	140.865	0.000
136.075	136.075	0.000
136.775	136.775	0.000
141.098	141.098	0.000
137.822	137.822	0.000
138.211	138.211	0.000
141.967	141.967	0.000
138.835	138.835	0.000
141.635	141.635	0.000
138.397	138.397	0.000
140.590	140.590	0.000
141.717	141.717	0.000
141.202	141.202	0.000
141.467	141.467	0.000
141.735	141.735	0.000
141.635	141.635	0.000
142.088	142.088	0.000
141.017	141.017	0.000
142.512	142.512	0.000
142.595	142.595	0.000
142.664	142.664	0.000
140.594	140.594	0.000
140.594	140.594	0.000
142.739	142.739	0.000
140.992	140.992	0.000
142.741	142.741	0.000
142.722	142.722	0.000
141.418	141.418	0.000
142.667	142.667	0.000
142.111	142.111	0.000
142.504	142.504	0.000
142.445	142.445	0.000
142.551	142.551	0.000
142.502	142.502	0.000
142.589	142.589	0.000
142.879	142.879	0.000
142.782	142.782	0.000
143.073	143.073	0.000
143.065	143.065	0.000
143.138	143.138	0.000

PUNTO KILOMÉTRICO : 29+180

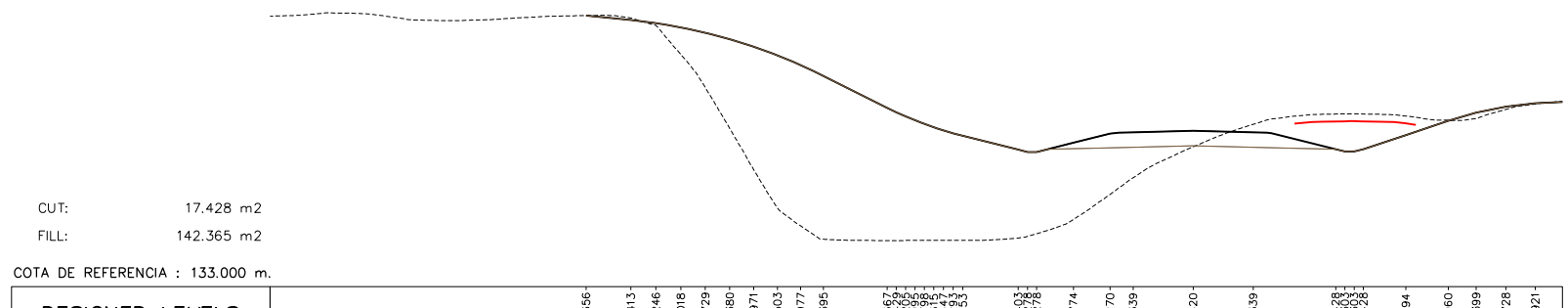

CUT: 17.428 m2
 FILL: 142.365 m2
 COTA DE REFERENCIA : 133.000 m.

DESIGNED LEVELS	EXISTING LEVELS	OFFSET
147.627	147.627	0.000
147.650	147.650	0.000
147.672	147.672	0.000
147.805	147.805	0.000
147.780	147.780	0.000
147.744	147.744	0.000
147.655	147.655	0.000
147.430	147.430	0.000
147.388	147.388	0.000
147.388	147.388	0.000
147.398	147.398	0.000
147.459	147.459	0.000
147.545	147.545	0.000
147.585	147.585	0.000
147.633	147.633	0.000
147.634	147.634	0.000
147.650	147.650	0.000
147.656	147.656	0.000
147.676	147.676	0.000
147.719	147.719	0.000
147.413	147.413	0.000
147.246	147.246	0.000
147.018	147.018	0.000
146.729	146.729	0.000
146.380	146.380	0.000
145.971	145.971	0.000
145.503	145.503	0.000
145.033	145.033	0.000
144.977	144.977	0.000
144.395	144.395	0.000
135.494	135.494	0.000
135.488	135.488	0.000
135.491	135.491	0.000
135.499	135.499	0.000
135.499	135.499	0.000
135.505	135.505	0.000
135.505	135.505	0.000
135.505	135.505	0.000
141.753	141.753	0.000
135.562	135.562	0.000
140.992	140.992	0.000
140.991	140.991	0.000
140.865	140.865	0.000
136.003	136.003	0.000
136.637	136.637	0.000
140.774	140.774	0.000
137.211	137.211	0.000
137.864	137.864	0.000
141.270	141.270	0.000
138.746	138.746	0.000
141.339	141.339	0.000
139.663	139.663	0.000
140.112	140.112	0.000
141.420	141.420	0.000
140.992	140.992	0.000
141.368	141.368	0.000
141.551	141.551	0.000
141.339	141.339	0.000
142.039	142.039	0.000
142.217	142.217	0.000
142.296	142.296	0.000
142.314	142.314	0.000
140.308	140.308	0.000
140.308	140.308	0.000
142.336	142.336	0.000
140.992	140.992	0.000
142.318	142.318	0.000
142.229	142.229	0.000
141.194	141.194	0.000
142.044	142.044	0.000
142.001	142.001	0.000
141.960	141.960	0.000
141.962	141.962	0.000
142.088	142.088	0.000
142.322	142.322	0.000
142.728	142.728	0.000
142.921	142.921	0.000
142.932	142.932	0.000
143.002	143.002	0.000

PUNTO KILOMÉTRICO : 29+160

CUT: 9.099 m2
 FILL: 1.143 m2

COTA DE REFERENCIA : 133.000 m.

DESIGNED LEVELS	EXISTING LEVELS	OFFSET
140.316	140.316	
139.571	139.571	
138.314	138.314	
137.582	137.582	
137.243	137.243	
136.636	136.636	
136.255	136.255	
135.812	135.812	
135.440	135.440	-8.451
135.389	135.389	-7.239
135.539	135.539	-5.744
135.912	135.912	-3.250
135.315	135.315	0.000
135.511	135.511	3.250
135.924	135.924	3.250
136.330	136.330	3.250
136.411	136.411	3.250
136.292	136.292	3.250
136.260	136.260	3.250
136.231	136.231	3.250
136.211	136.211	3.250
136.097	136.097	3.250
135.885	135.885	3.250
135.985	135.985	3.250
135.989	135.989	3.250
135.701	135.701	3.250
135.883	135.883	3.250
136.133	136.133	3.250
136.132	136.132	3.250
136.154	136.154	3.250
136.147	136.147	3.250
136.135	136.135	3.250
136.042	136.042	3.250
135.929	135.929	3.250
135.860	135.860	3.250
135.788	135.788	3.250

PUNTO KILOMÉTRICO : 29+440

CUT: 18.292 m2
 FILL: 0.000 m2

COTA DE REFERENCIA : 131.000 m.

DESIGNED LEVELS	EXISTING LEVELS	OFFSET
134.211	134.211	
134.205	134.205	
134.183	134.183	
134.176	134.176	-13.993
134.139	134.139	-12.382
134.027	134.027	-12.786
133.982	133.982	-11.001
134.453	134.453	-8.221
133.137	133.137	-8.721
133.073	133.073	-8.721
133.137	133.137	-7.721
134.029	134.029	-7.721
133.863	133.863	-3.250
133.850	133.850	-3.250
133.844	133.844	-3.250
134.049	134.049	0.000
133.864	133.864	0.000
133.865	133.865	0.000
133.875	133.875	0.000
133.875	133.875	3.250
133.992	133.992	3.250
133.989	133.989	3.250
133.992	133.992	3.250
134.048	134.048	7.721
134.062	134.062	8.721
133.137	133.137	8.721
133.073	133.073	8.721
133.137	133.137	10.445
134.029	134.029	10.445
133.791	133.791	11.044
133.443	133.443	11.044
133.653	133.653	11.044
133.593	133.593	11.044
133.296	133.296	11.044
133.210	133.210	11.044
133.157	133.157	11.044
133.170	133.170	11.044
133.237	133.237	11.044
133.261	133.261	11.044
133.267	133.267	11.044
133.273	133.273	11.044

PUNTO KILOMÉTRICO : 29+500

CUT: 4.443 m2
 FILL: 4.595 m2

COTA DE REFERENCIA : 133.000 m.

DESIGNED LEVELS	EXISTING LEVELS	OFFSET
141.729	141.729	
141.264	141.264	
140.040	140.040	
138.961	138.961	
137.675	137.675	
136.889	136.889	
136.458	136.458	
135.957	135.957	-8.224
135.813	135.813	-8.011
135.106	135.106	-8.011
135.576	135.576	-6.131
135.309	135.309	-3.250
135.637	135.637	0.000
137.090	137.090	3.250
135.886	135.886	3.250
136.081	136.081	3.250
136.473	136.473	3.250
136.545	136.545	3.250
137.171	137.171	3.250
136.606	136.606	3.250
136.636	136.636	3.250
136.650	136.650	3.250
137.090	137.090	3.250
136.651	136.651	3.250
136.723	136.723	3.250
136.762	136.762	3.250
136.804	136.804	3.250
136.803	136.803	3.250
136.800	136.800	3.250
136.683	136.683	3.250
136.488	136.488	3.250
136.357	136.357	3.250

PUNTO KILOMÉTRICO : 29+420

CUT: 15.756 m2
 FILL: 0.000 m2

COTA DE REFERENCIA : 131.000 m.

DESIGNED LEVELS	EXISTING LEVELS	OFFSET
135.573	135.573	
135.307	135.307	
135.031	135.031	
134.923	134.923	
134.892	134.892	
134.865	134.865	
134.820	134.820	
134.810	134.810	
134.807	134.807	-13.474
134.790	134.790	-12.866
134.658	134.658	-12.261
134.278	134.278	-10.741
133.898	133.898	-8.221
133.771	133.771	-8.721
133.698	133.698	-7.721
134.651	134.651	-4.000
134.660	134.660	-3.250
134.687	134.687	-3.250
134.790	134.790	-3.250
134.809	134.809	-3.250
134.737	134.737	-3.250
134.755	134.755	0.000
134.701	134.701	0.000
134.890	134.890	3.250
134.546	134.546	3.250
134.552	134.552	3.250
134.660	134.660	7.721
133.898	133.898	8.721
133.771	133.771	8.721
133.698	133.698	9.221
134.783	134.783	10.529
134.224	134.224	10.529
134.828	134.828	11.044
134.651	134.651	11.044
134.751	134.751	11.044
134.653	134.653	11.044
134.701	134.701	11.044
134.580	134.580	11.044
134.623	134.623	11.044
134.586	134.586	11.044
134.589	134.589	11.044

PUNTO KILOMÉTRICO : 29+480

CUT: 1.555 m2
 FILL: 11.553 m2

COTA DE REFERENCIA : 133.000 m.

DESIGNED LEVELS	EXISTING LEVELS	OFFSET
143.333	143.333	
141.865	141.865	
141.068	141.068	
140.536	140.536	
139.621	139.621	
139.044	139.044	
138.037	138.037	
137.071	137.071	
136.655	136.655	-8.487
136.607	136.607	-8.269
136.802	136.802	-8.269
137.304	137.304	-6.260
135.862	135.862	-4.000
135.654	135.654	-3.250
137.831	137.831	0.000
137.850	137.850	3.250
135.950	135.950	3.250
135.797	135.797	3.250
135.614	135.614	3.250
137.931	137.931	3.250
136.914	136.914	3.250
137.850	137.850	3.250
137.851	137.851	3.250
137.615	137.615	3.250
137.312	137.312	3.250
137.274	137.274	3.250
137.297	137.297	3.250
137.401	137.401	3.250
136.877	136.877	3.250
137.453	137.453	3.250
136.815	136.815	3.250
137.500	137.500	3.250
137.172	137.172	3.250
137.289	137.289	3.250
137.313	137.313	3.250
137.326	137.326	3.250
137.324	137.324	3.250
137.338	137.338	3.250
137.368	137.368	3.250
137.395	137.395	3.250
137.421	137.421	3.250
137.487	137.487	3.250
137.497	137.497	3.250
137.499	137.499	3.250

PUNTO KILOMÉTRICO : 29+400

CUT: 9.204 m2
 FILL: 2.028 m2

COTA DE REFERENCIA : 132.000 m.

DESIGNED LEVELS	EXISTING LEVELS	OFFSET
139.813	139.813	
139.259	139.259	-19.532
138.034	138.034	-13.693
138.166	138.166	-13.693
137.772	137.772	-14.376
137.306	137.306	-14.376
136.885	136.885	-14.376
136.484	136.484	-13.621
136.121	136.121	-13.621
135.715	135.715	-13.621
135.418	135.418	-13.621
135.207	135.207	-13.621
134.833	134.833	-13.621
134.658	134.658	-13.621
135.034	135.034	-6.831
135.020	135.020	-5.270
134.996	134.996	-4.934
135.184	135.184	-4.934
135.355	135.355	-4.934
135.075	135.075	-3.250
135.569	135.569	-3.250
135.109	135.109	0.000
135.130	135.130	0.000
135.651	135.651	3.250
135.142	135.142	3.250
135.159	135.159	3.250
135.190	135.190	3.250
135.327	135.327	7.721
134.658	134.658	8.721
134.333	134.333	8.721
134.658	134.658	9.221
134.418	134.418	10.581
134.998	134.998	10.581
135.431	135.431	11.941
135.239	135.239	11.941
135.462	135.462	11.941
135.487	135.487	11.941
135.487	135.487	11.941
135.490	135.490	11.941
135.452	135.452	11.941
135.343	135.343	11.941
135.318	135.318	11.941
135.281	135.281	11.941
135.428	135.428	11.941
135.465	135.465	11.941

PUNTO KILOMÉTRICO : 29+460

CUT: 6.105 m2
 FILL: 4.940 m2

COTA DE REFERENCIA : 127.000 m.

DESIGNED LEVELS	EXISTING LEVELS	OFFSET
133.091	133.104	
	133.140	
	133.212	
	133.270	
	133.162	
	133.048	
	132.444	
	131.965	
	131.559	
	131.257	
	130.870	
	130.416	
	130.276	
	130.433	
	130.565	
	131.230	
	131.196	
	131.631	
	131.717	
	131.691	
	131.635	
	131.768	
	131.359	
	131.252	
	130.843	
	130.200	
	130.019	
	130.652	
	129.816	
	129.246	
	129.288	
	129.579	
	13.435	
	129.359	
	129.467	
	14.046	
	129.499	
	129.429	
	129.728	
	129.852	
	129.780	
	129.787	
	129.872	

PUNTO KILOMÉTRICO : 29+560

CUT: 35.104 m2
 FILL: 0.000 m2

COTA DE REFERENCIA : 126.000 m.

DESIGNED LEVELS	EXISTING LEVELS	OFFSET
131.657	131.644	
131.593	131.606	
131.401	131.728	
	131.754	
	131.756	
	131.824	
	131.836	
	131.813	
	131.501	
	131.284	
	130.939	
	130.680	
	130.173	
	129.760	
	129.750	
	129.619	
	129.740	
	129.637	
	129.756	
	129.774	
	129.782	
	129.764	
	129.699	
	129.627	
	129.637	
	129.619	
	129.539	
	129.540	
	129.540	
	129.595	
	129.595	
	129.592	
	129.726	
	129.601	
	128.726	
	129.586	
	128.937	
	129.516	
	129.416	
	129.243	
	129.249	
	129.298	
	129.170	
	129.015	
	128.939	
	128.796	
	128.605	
	128.489	

PUNTO KILOMÉTRICO : 29+620

CUT: 8.018 m2
 FILL: 2.554 m2

COTA DE REFERENCIA : 128.000 m.

DESIGNED LEVELS	EXISTING LEVELS	OFFSET
133.779	133.795	
	133.795	
	133.826	
	133.826	
	133.884	
	133.917	
	133.917	
	133.745	
	133.505	
	133.079	
	132.751	
	132.144	
	131.902	
	131.590	
	131.702	
	131.175	
	130.984	
	132.094	
	131.198	
	131.460	
	132.528	
	132.139	
	132.610	
	132.459	
	132.503	
	132.511	
	132.528	
	132.508	
	132.487	
	132.440	
	132.440	
	132.365	
	132.241	
	132.066	
	131.697	
	131.442	
	131.810	
	131.780	
	131.648	
	131.450	
	131.386	
	131.328	
	131.329	
	131.343	
	131.351	
	131.372	
	131.381	
	131.392	
	131.392	

PUNTO KILOMÉTRICO : 29+540

CUT: 24.485 m2
 FILL: 0.033 m2

COTA DE REFERENCIA : 126.000 m.

DESIGNED LEVELS	EXISTING LEVELS	OFFSET
132.530	132.530	
132.517	132.517	
132.534	132.534	
132.592	132.592	
132.643	132.643	
132.656	132.656	
132.684	132.684	
132.631	132.631	
132.453	132.453	
132.319	132.319	
130.730	130.730	
132.034	132.034	
131.607	131.607	
131.434	131.434	
131.149	131.149	
130.711	130.711	
130.289	130.289	
130.302	130.302	
130.344	130.344	
130.359	130.359	
130.308	130.308	
130.383	130.383	
130.395	130.395	
130.389	130.389	
130.308	130.308	
130.298	130.298	
130.087	130.087	
129.970	129.970	
129.874	129.874	
129.878	129.878	
129.840	129.840	
129.793	129.793	
129.711	129.711	
129.665	129.665	
129.596	129.596	
129.469	129.469	
129.546	129.546	
129.264	129.264	
129.187	129.187	
129.115	129.115	
129.045	129.045	
128.936	128.936	
128.769	128.769	
128.622	128.622	
128.448	128.448	

PUNTO KILOMÉTRICO : 29+600

CUT: 14.647 m2
 FILL: 0.000 m2

COTA DE REFERENCIA : 130.000 m.

DESIGNED LEVELS	EXISTING LEVELS	OFFSET
133.464	133.464	
133.433	133.433	
	133.312	
	133.173	
	133.132	
	132.991	
	132.884	
	133.091	
	133.069	
	133.046	
	132.951	
	132.377	
	132.992	
	133.003	
	133.018	
	133.289	
	133.018	
	133.069	
	133.370	
	133.170	
	133.206	
	133.269	
	133.289	
	133.292	
	133.314	
	133.315	
	133.308	
	133.258	
	133.277	
	133.173	
	133.071	
	132.971	
	133.052	
	132.558	
	9.946	
	132.957	
	132.740	
	132.890	
	132.880	
	11.884	
	132.888	
	132.887	
	132.901	
	132.916	
	132.936	
	132.932	
	132.932	
	132.922	
	132.919	
	132.921	

PUNTO KILOMÉTRICO : 29+520

CUT: 14.592 m2
 FILL: 1.432 m2

COTA DE REFERENCIA : 127.000 m.

DESIGNED LEVELS	EXISTING LEVELS	OFFSET
132.931	132.931	
132.943	132.943	
132.875	132.875	
132.922	132.922	
132.685	132.685	
132.481	132.481	
132.208	132.208	
131.395	131.395	
131.494	131.494	
131.136	131.136	
130.857	130.857	
130.630	130.630	
130.585	130.585	
130.567	130.567	
130.553	130.553	
130.593	130.593	
130.697	130.697	
130.792	130.792	
130.968	130.968	
130.992	130.992	
131.006	131.006	
131.000	131.000	
130.969	130.969	
130.727	130.727	
130.580	130.580	
130.448	130.448	
130.143	130.143	
130.217	130.217	
129.457	129.457	
129.181	129.181	
129.221	129.221	
129.268	129.268	
129.306	129.306	
129.334	129.334	
129.491	129.491	
129.528	129.528	
129.494	129.494	
129.411	129.411	
128.573	128.573	
128.241	128.241	

PUNTO KILOMÉTRICO : 29+580

CUT: 13.787 m2
 FILL: 0.051 m2

COTA DE REFERENCIA : 123.000 m.

DESIGNED LEVELS	EXISTING LEVELS	OFFSET
	128.171	
	128.077	
	128.026	
	127.972	
	127.896	
	127.821	
	127.679	
	127.486	
	127.336	
	127.408	
	127.269	
	127.125	
	126.983	
	126.851	
	126.721	
	127.851	
	128.077	
	128.094	
	128.136	
	128.129	
	128.116	
	128.103	
	128.092	
	128.042	
	127.838	
	127.497	
	127.085	
	126.833	
	126.637	
	126.572	
	126.518	
	126.473	
	126.426	
	126.373	
	126.334	
	126.281	
	126.130	
	126.064	
	125.914	

PUNTO KILOMÉTRICO : 29+680

CUT: 15.754 m2
 FILL: 0.055 m2

COTA DE REFERENCIA : 124.000 m.

DESIGNED LEVELS	EXISTING LEVELS	OFFSET
	128.357	
	128.347	
	128.329	
	128.306	
	128.200	
	128.090	
	128.991	
	128.866	
	128.779	
	128.674	
	128.668	
	128.621	
	128.089	
	127.504	
	127.373	
	127.304	
	128.276	
	128.534	
	128.593	
	128.597	
	128.708	
	128.416	
	128.738	
	128.765	
	128.751	
	128.497	
	128.744	
	128.512	
	128.516	
	128.416	
	128.188	
	127.676	
	127.988	
	127.572	
	127.605	
	127.494	
	127.441	
	127.352	
	127.533	
	127.362	
	127.336	
	127.308	
	127.272	
	127.250	
	127.221	
	127.159	
	127.131	
	127.012	

PUNTO KILOMÉTRICO : 29+660

CUT: 24.025 m2
 FILL: 0.000 m2

COTA DE REFERENCIA : 125.000 m.

DESIGNED LEVELS	EXISTING LEVELS	OFFSET
	130.303	
	130.237	
	130.146	
	130.072	
	130.071	
	130.006	
	129.814	
	129.814	
	128.955	
	130.071	
	130.119	
	130.145	
	130.145	
	129.148	
	129.140	
	129.186	
	129.186	
	129.200	
	129.089	
	129.166	
	128.937	
	129.006	
	128.803	
	128.713	
	128.690	
	128.689	
	128.689	
	128.574	
	128.601	
	128.432	
	128.235	
	128.315	
	128.311	
	128.172	
	128.122	
	128.079	
	128.041	
	127.936	
	127.851	
	127.803	
	127.740	

PUNTO KILOMÉTRICO : 29+640

CUT: 11.987 m2
 FILL: 1.007 m2

COTA DE REFERENCIA : 122.000 m.

DESIGNED LEVELS	EXISTING LEVELS	OFFSET
	127.617	
	127.374	
	127.089	
	126.779	
	126.475	
	126.017	
	125.722	
	125.851	
	126.099	
	126.292	
	126.499	
	126.492	
	126.902	
	127.138	
	127.379	
	127.499	
	127.539	
	127.354	
	127.572	
	127.572	
	127.568	
	127.536	
	127.492	
	127.391	
	127.354	
	127.755	
	127.715	
	126.697	
	126.429	
	126.215	
	125.764	
	125.885	
	125.524	
	125.776	
	125.716	
	124.880	
	124.559	
	124.460	
	124.460	
	124.315	
	124.310	
	124.308	
	124.276	
	124.215	

PUNTO KILOMÉTRICO : 29+700