

# FÖRKLARINGAR

- BEFINTLIG MARKNIVÅ
- NYTT VÄGRÄCKE/GC-RÄCKE
- WK\_x.xx VÄGKANT, X METER FRÅN LINJE 202-GC
- WK\_GC\_x.xx VÄGKANT GC-BANA, X METER FRÅN LINJE 202-GC
- VM\_x.xx VÄGMITT (BEFINTLIG), X METER FRÅN LINJE 202-GC
- Ny\_VM\_x.xx NY VÄGMITT, X METER FRÅN LINJE 202-GC
- Bef\_VM BEFINTLIG VÄGMITT (VID VÄGMITTFÖRSKJUTNING)
- x.xx TVÄRFALL

# ANVISNINGAR

TVÄRSEKTIONER AVSER LINJE 202-GC

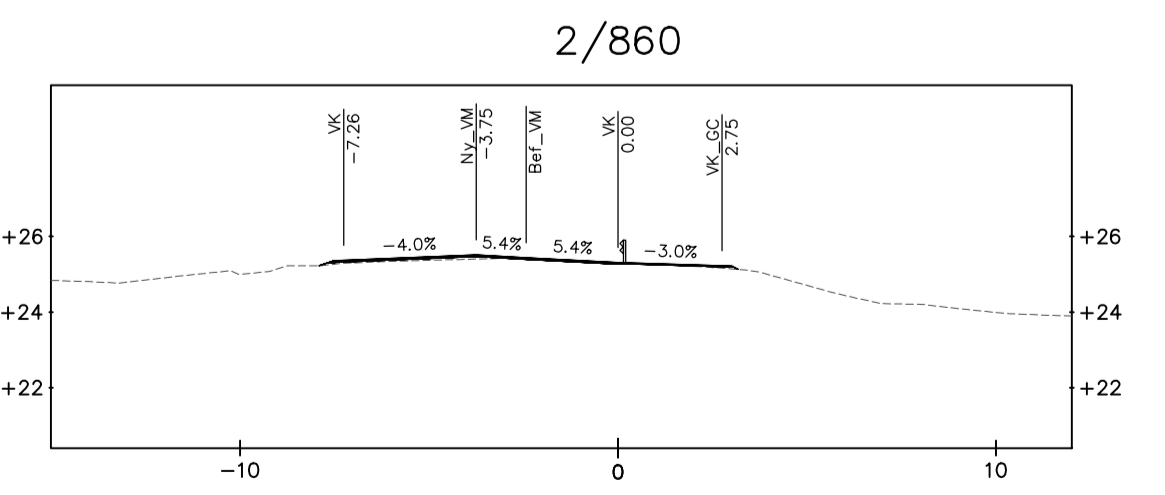
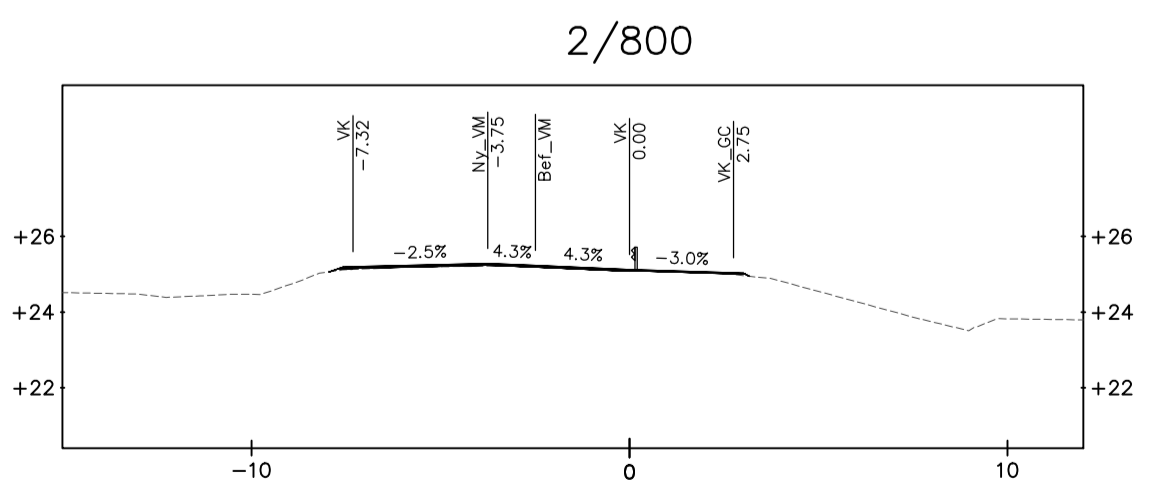
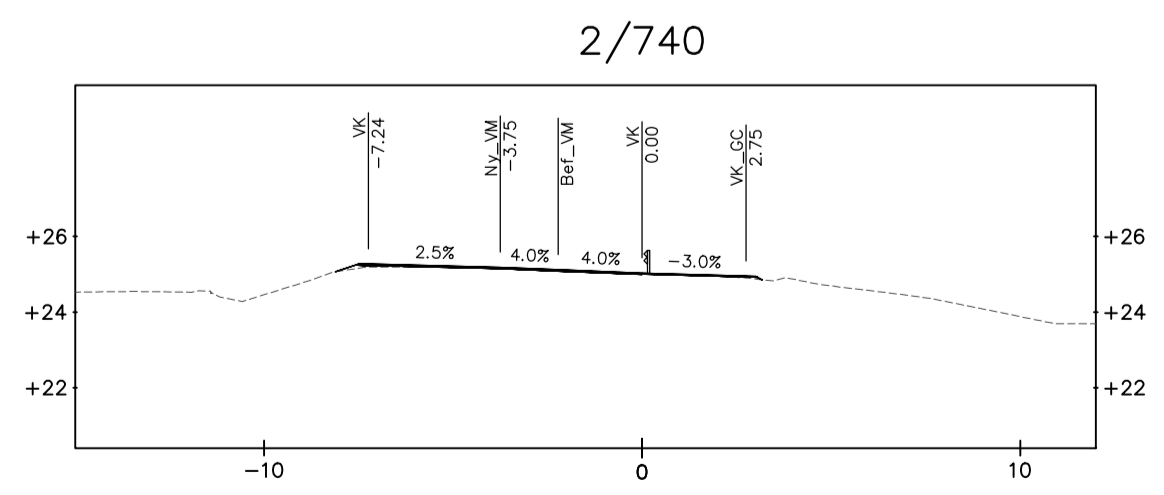
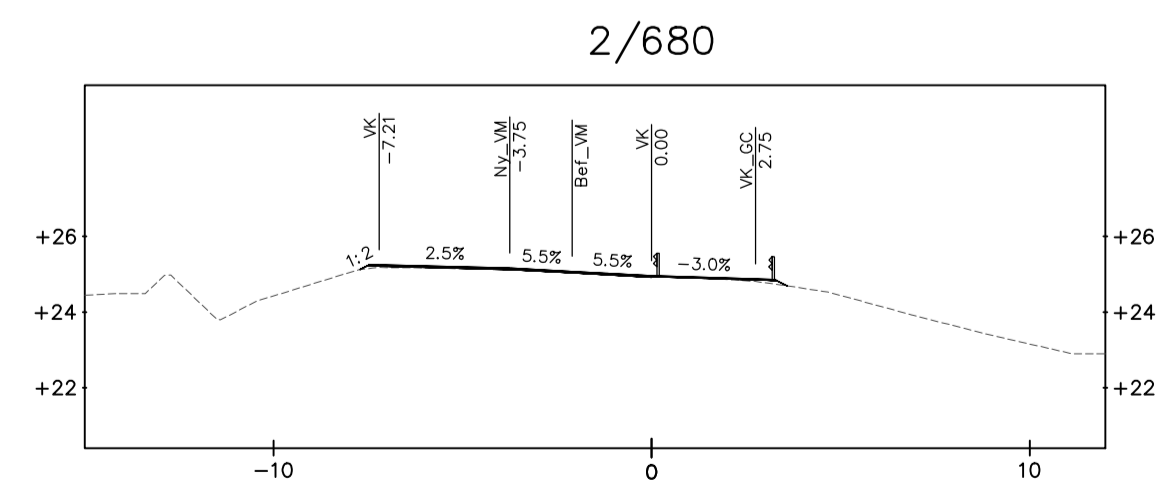
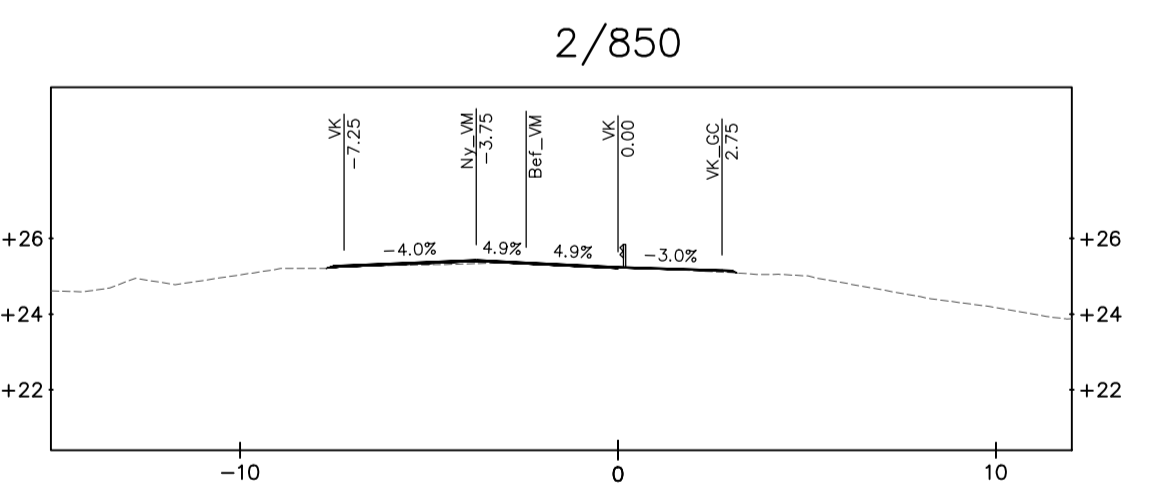
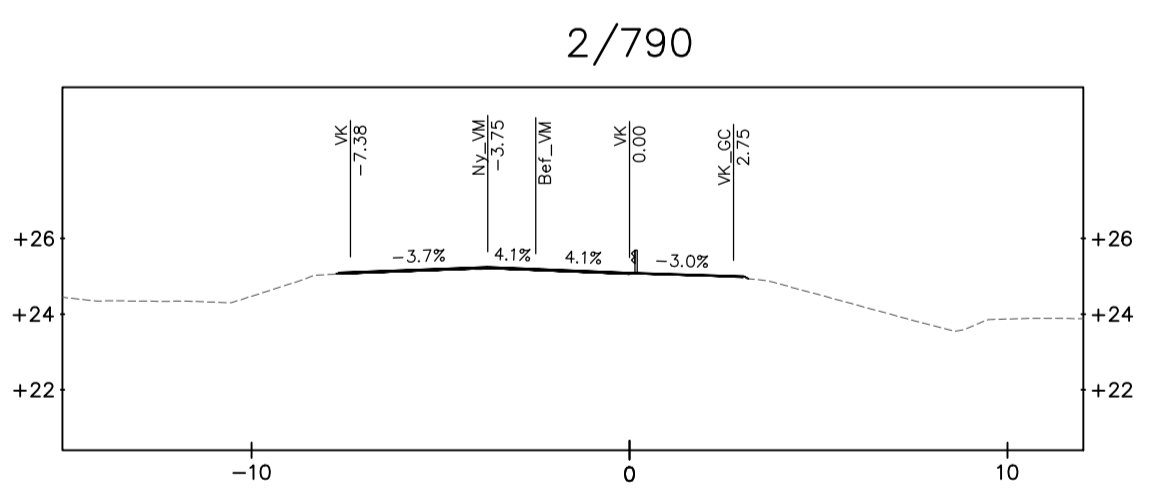
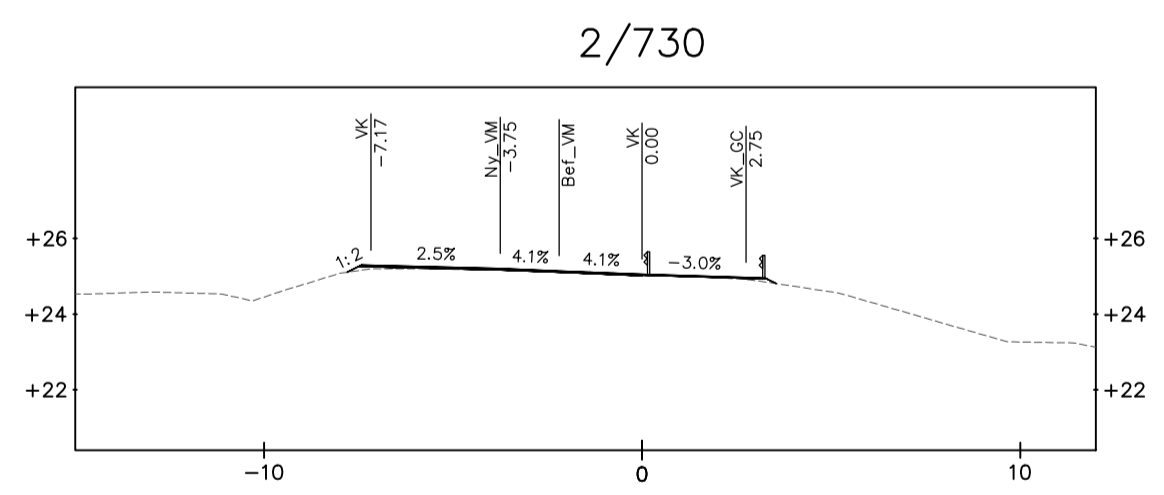
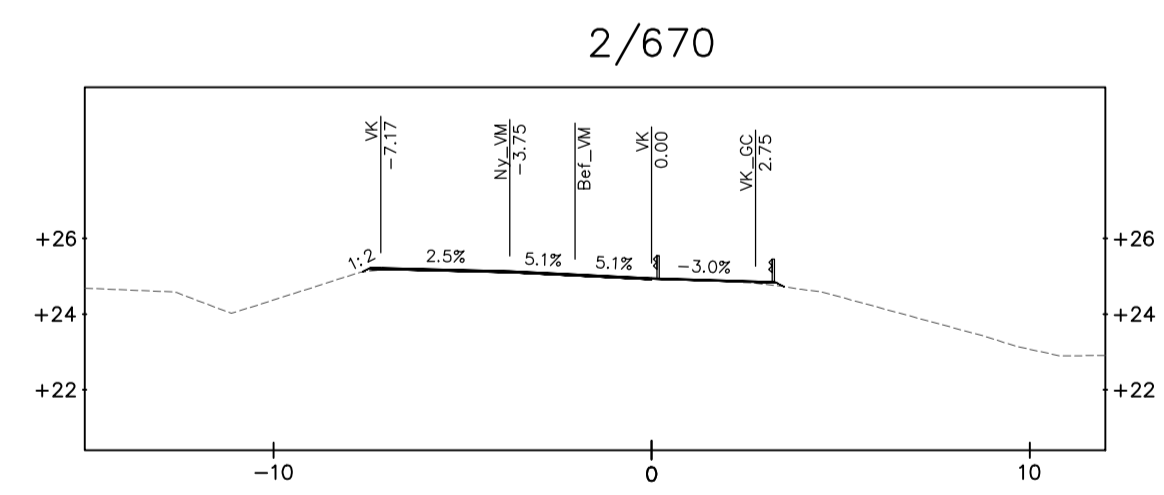
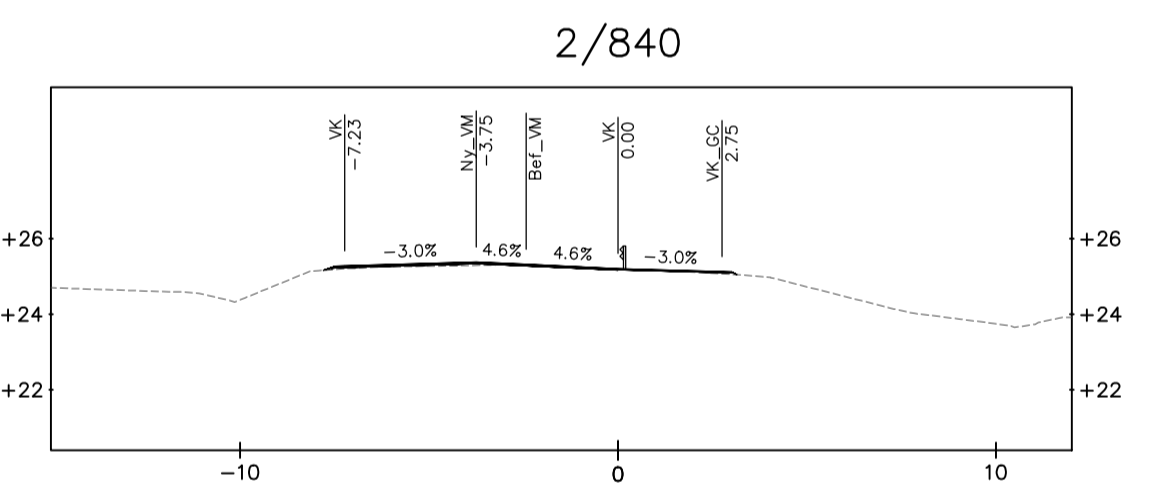
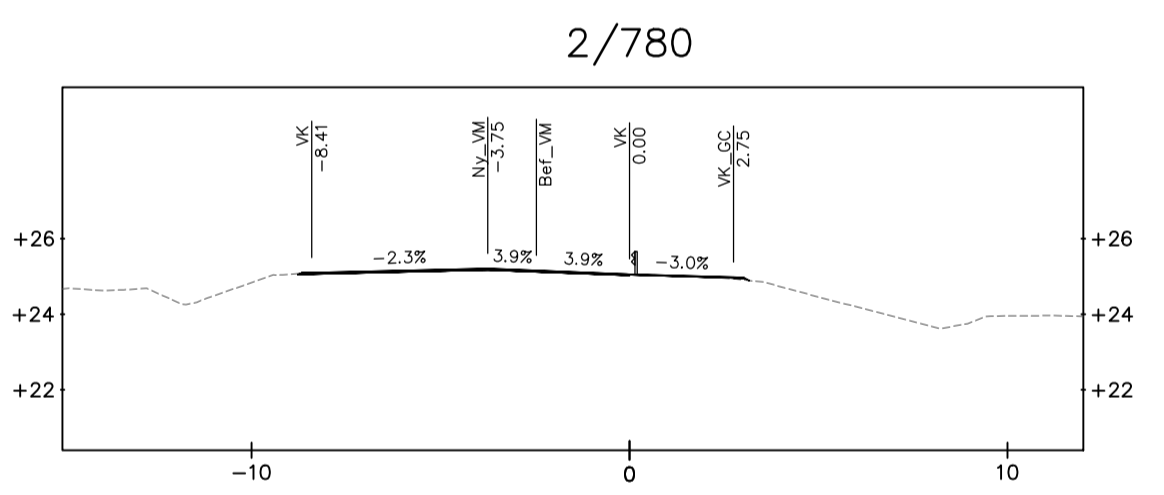
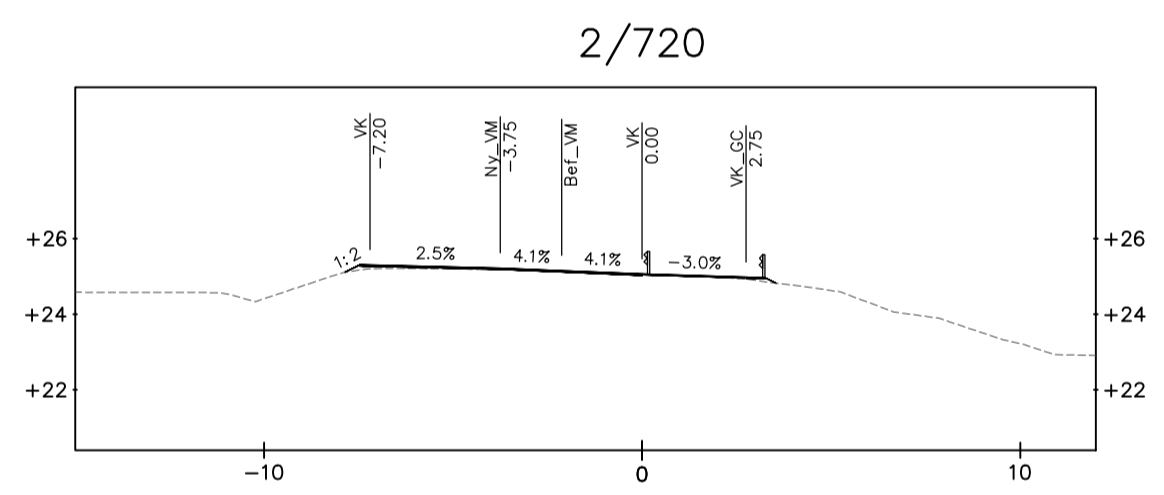
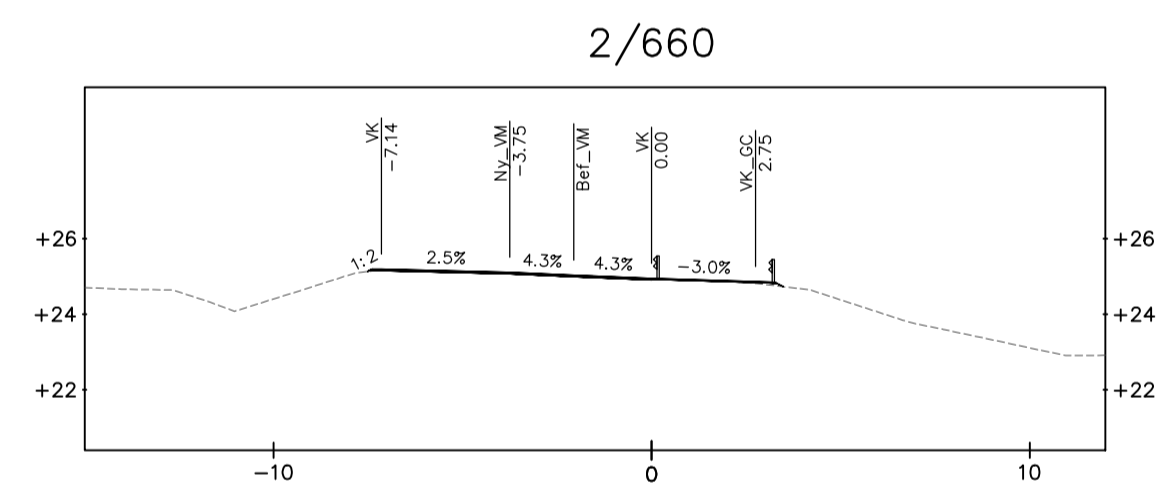
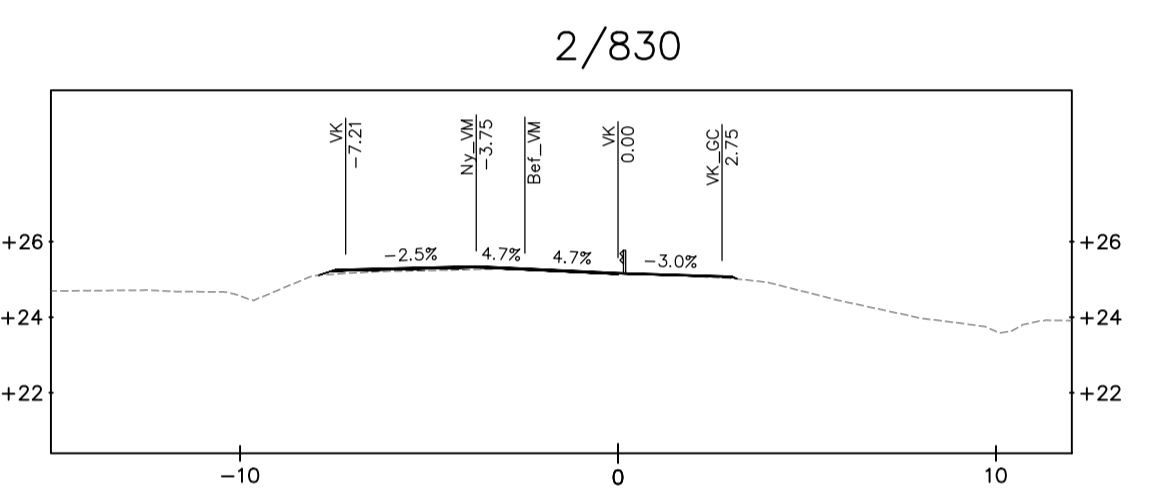
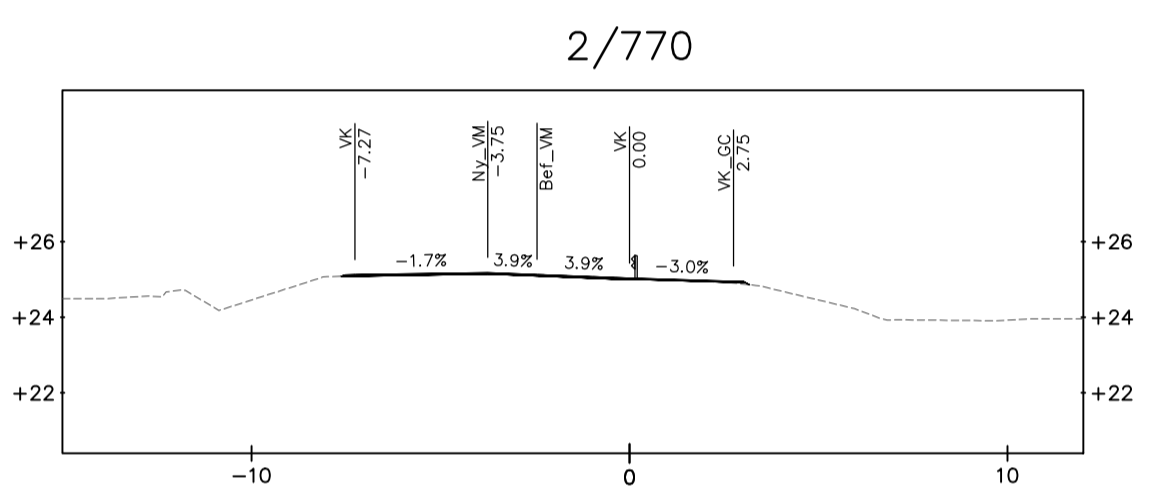
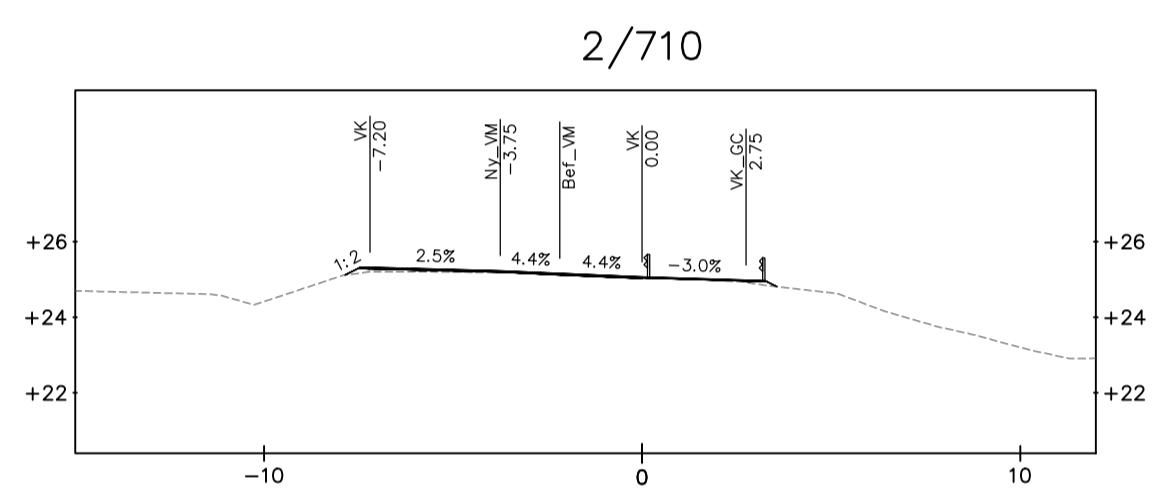
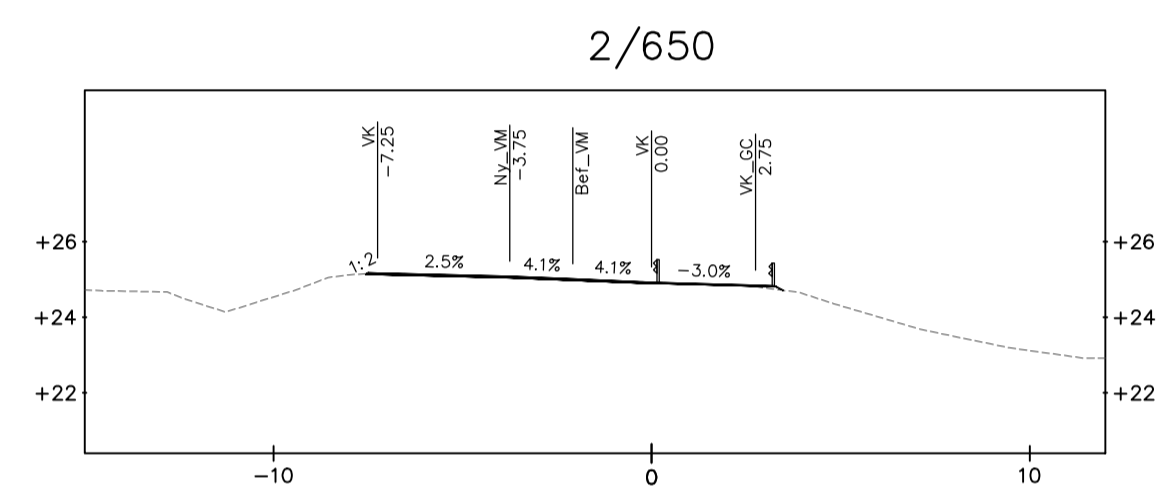
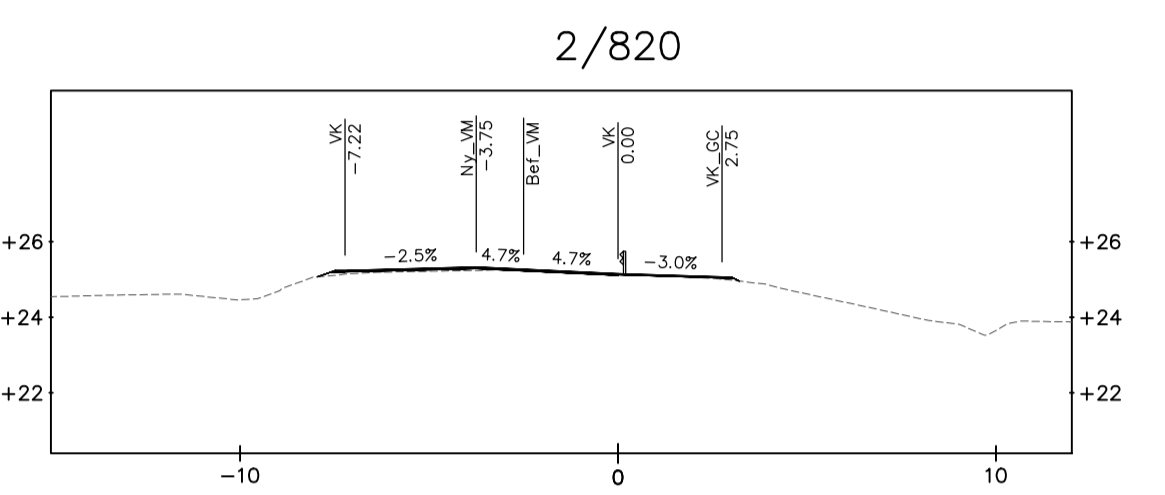
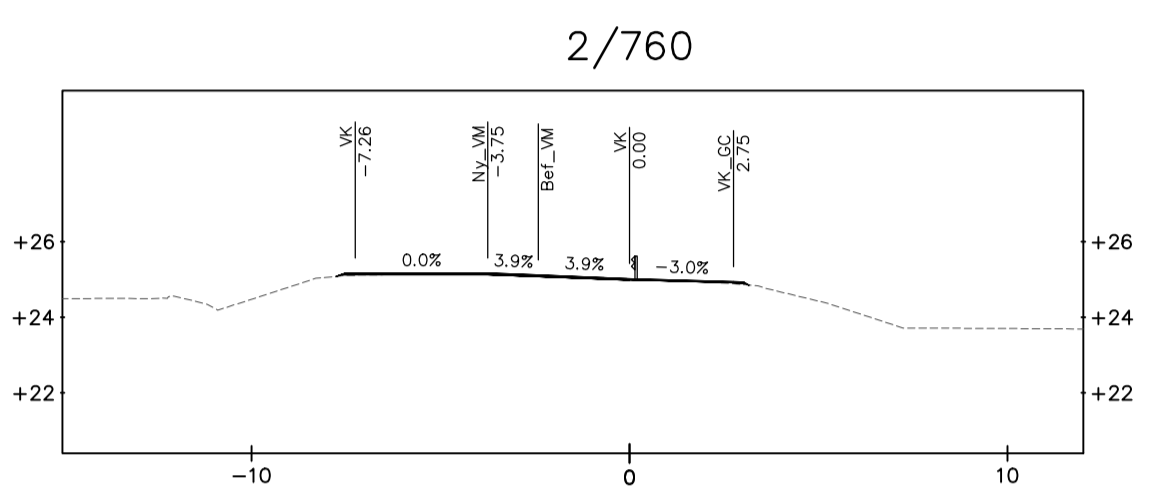
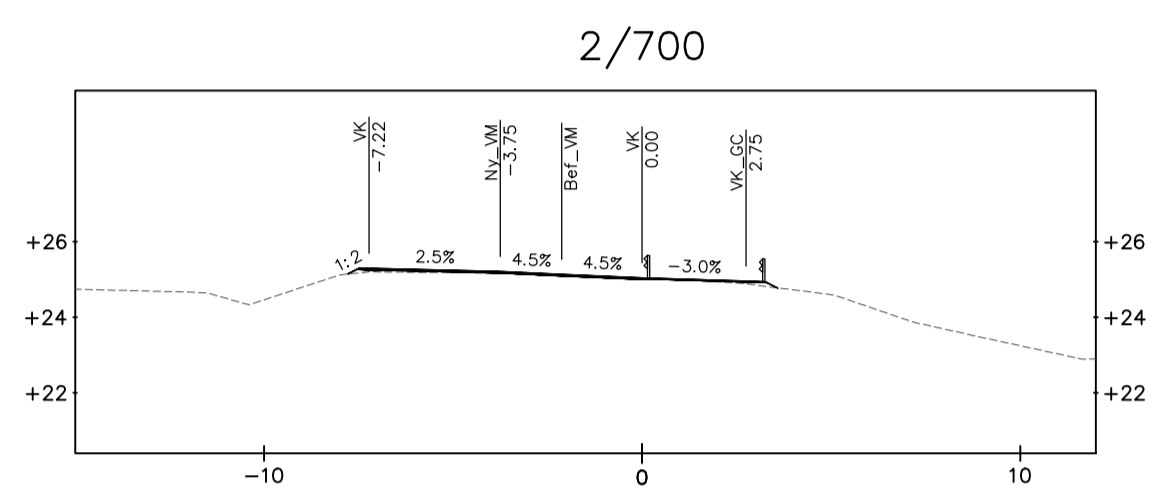
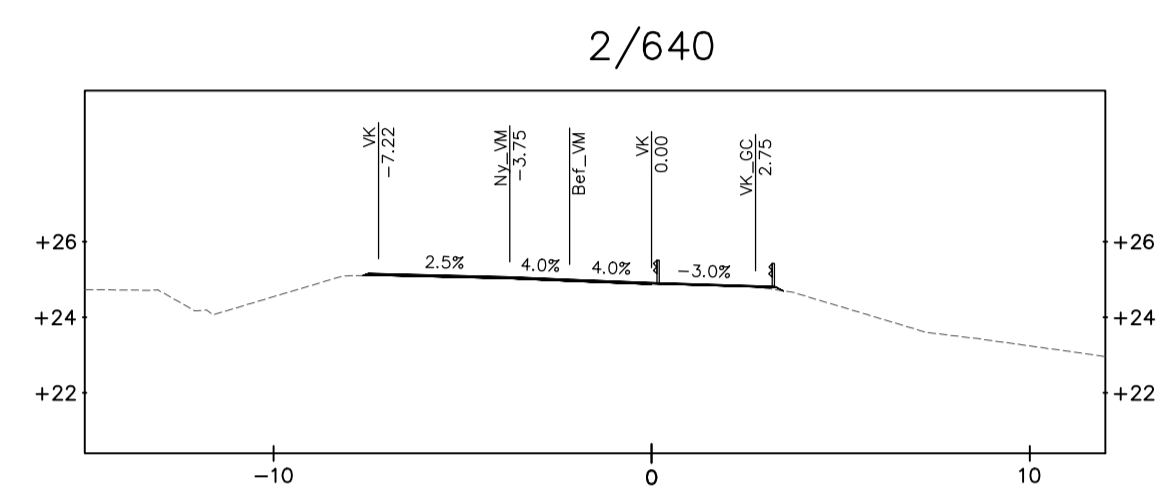
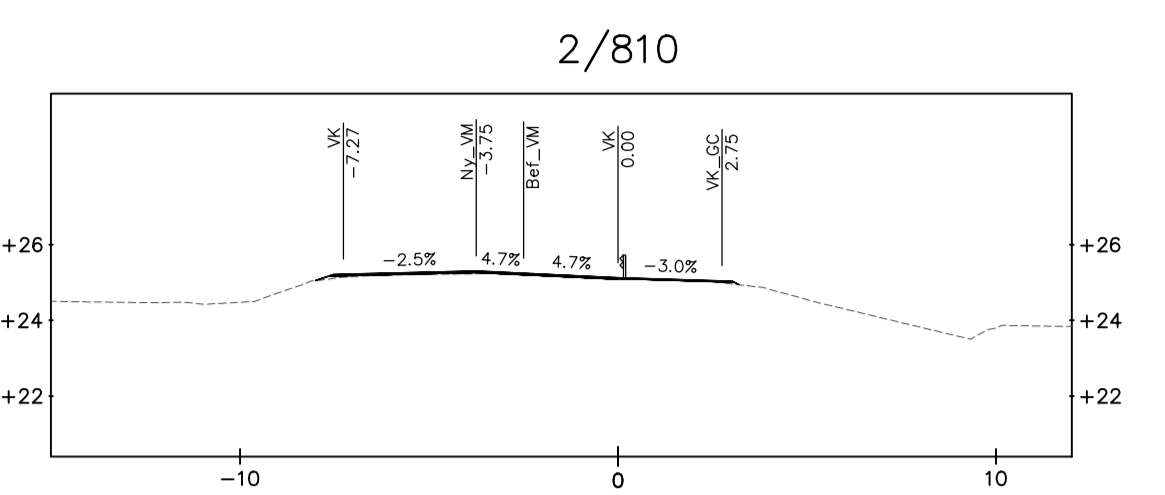
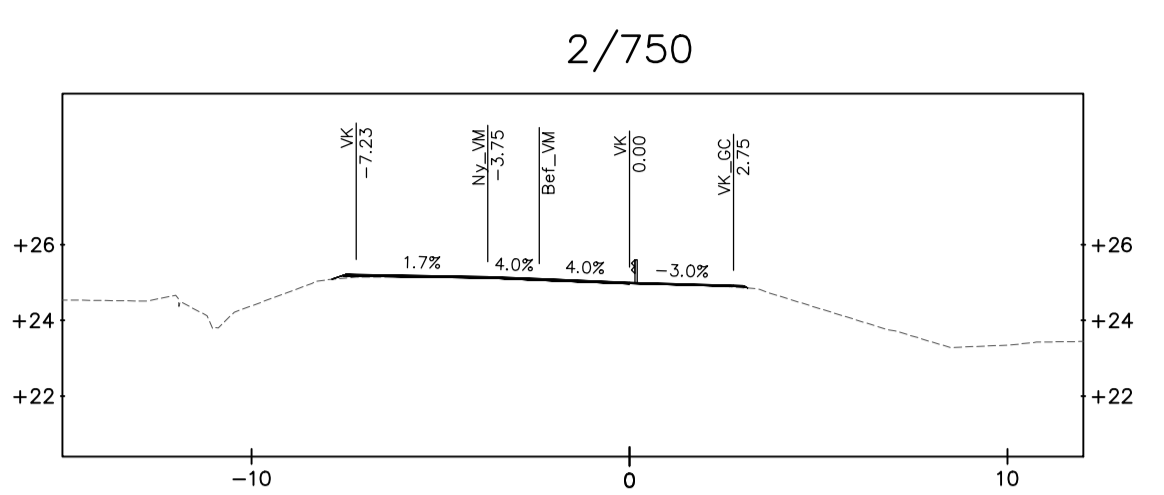
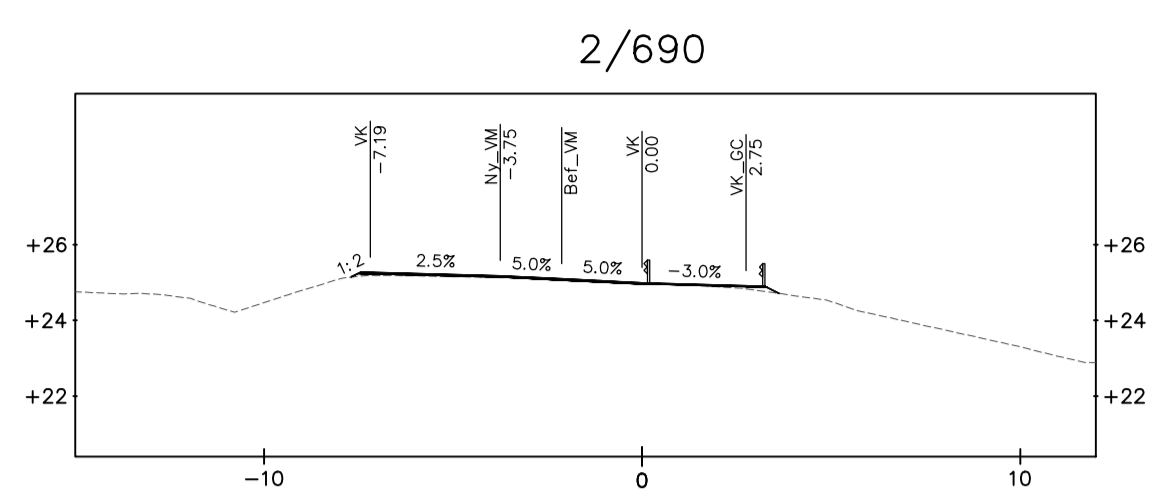
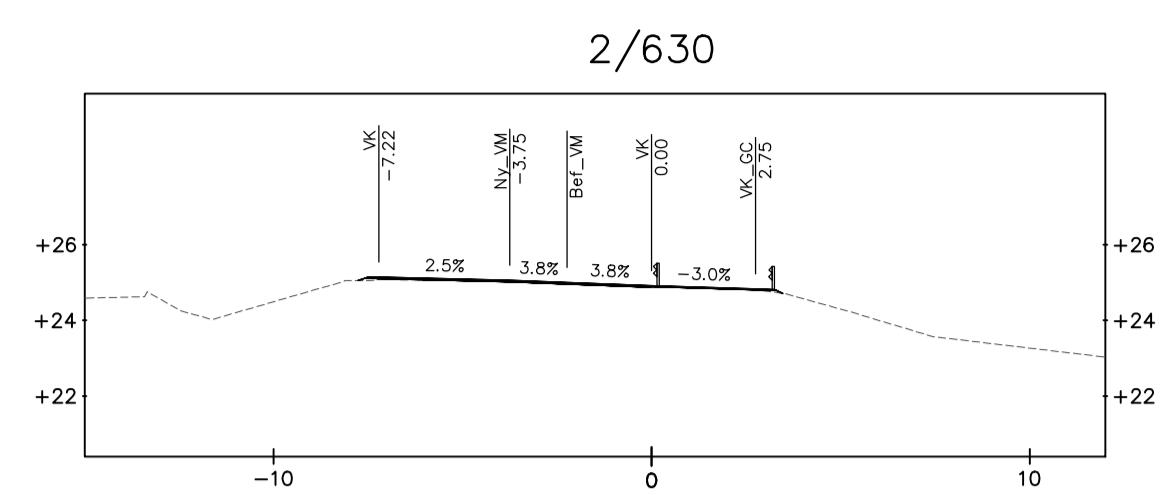

# KOORDINATSYSTEM

PLAN: SWEREF 99 18 00  
HÖJD: RH 2000

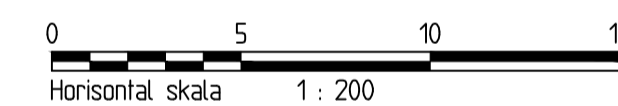

TYP AV PLAN		<b>VÄGPLAN</b>	
GRANSKNINGSSTATUS / SYFTE			
HANDLINGSTYP			
<b>GRANSKNINGSHANDLING</b>			
DATUM		LEVERANS / ÄNDRINGS-PM	
2024-04-04			
OBJEKT			
<b>GC-VÄG TIERP - TIERPS KYRKBY</b>			
DELOMRÅDE / BANDEL			
TIERP			
ANLÄGGNINGSDL			
TIERP - TIERPS KYRKBY			
OBJEKTNUMMER / KM	KONSTRUKTIONSNUMMER		
169470			
BESTÄLLARE	LEVERANTÖR		
<b>TRAFIKVERKET</b>	<b>SYSTRA</b>		
SKAPAD AV	UPPDRAGNUMMER		
M. VALL	2013741		
GODKÄND AV	ÄVDELNING		
J. NILSSON			
RITNINGSTYP			
<b>SEKTIONS-RITNING</b>			
TEKNIKOMRÅDE / INNEHÅLL			
VÄGUTFORMNING OCH TRAFIK			
BESKRIVNING			
TVÄRSEKTIONER LINJE 202-GC			
2/630 - 2/860			
SKALA	FORMAT	FÖRVALTNINGSNUMMER	
1:200	A1		
RITNINGSNUMMER	BLAD	NÄSTA BLAD	BET
2 02 T 09 12			